

PLOTDRVR Color\_Half.dwg  
BP-02  
PROJECT: City of Rochester - Midtown Redevelopment Drawings\Transportation\Contracting\Base Plan and Alternates\210301\_base\_plan.dgn  
DATE: 04/19/2011 10:38:01 AM

NOTES:

1. PAVEMENT REHABILITATION (MILL AND OVERLAY) IS ANTICIPATED ON BROAD STREET.
2. U-TURNS WOULD CONTINUE TO BE PERMITTED AT STONE STREET.
3. THE LOSS OF THREE OR FOUR PARKING SPACES IS ANTICIPATED ADJACENT TO THE LIBRARY.

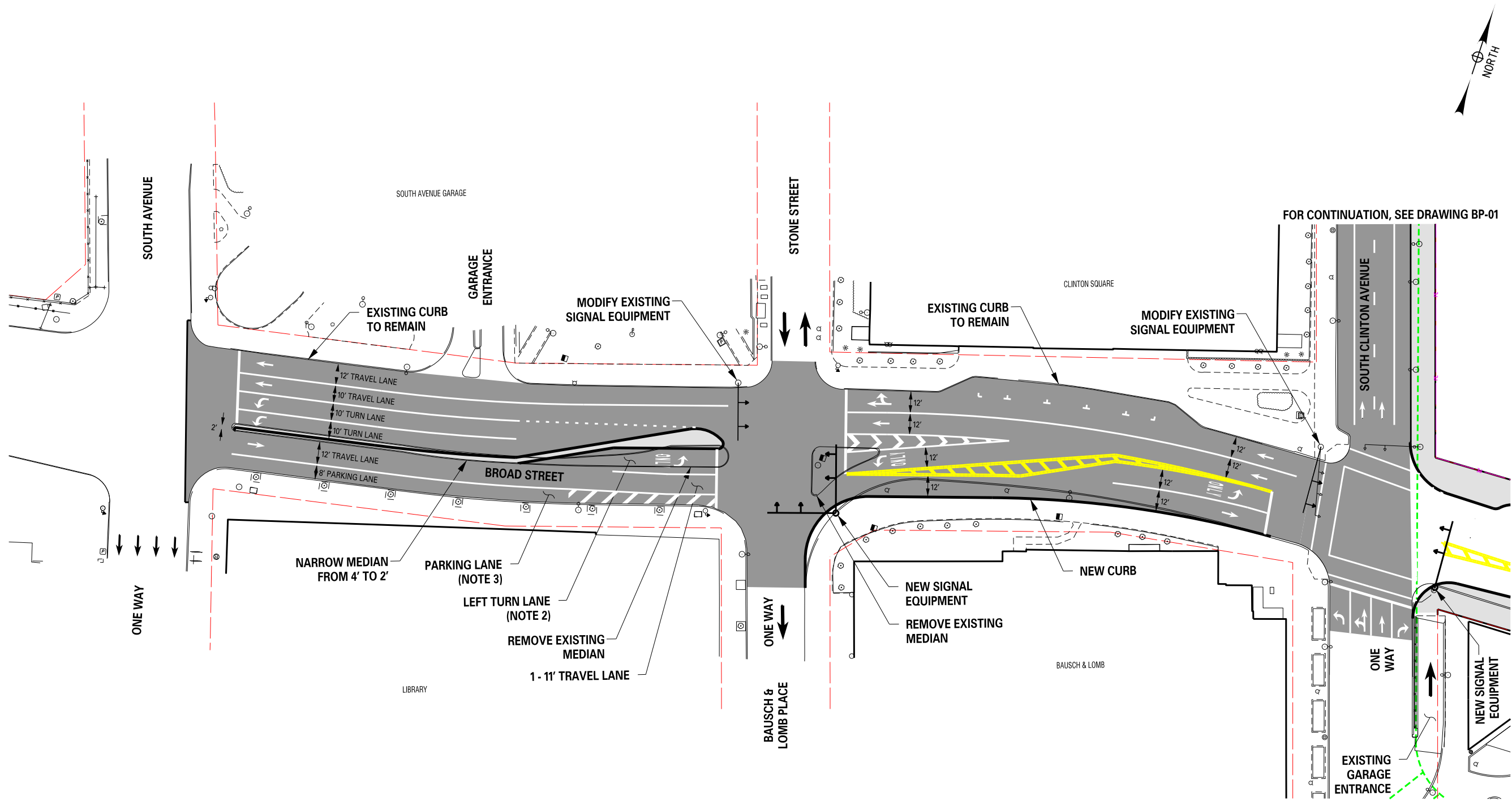

LEGEND

- PROPOSED PAETEC BUILDING
- PROPOSED MIDTOWN REDEVELOPMENT
- EXISTING PROPERTY LINES/HIGHWAY BOUNDARY
- PROPOSED PROPERTY LINES/HIGHWAY BOUNDARY
- EXISTING UNDERGROUND PARKING GARAGE
- PROPOSED TUNNEL
- EXISTING TUNNEL

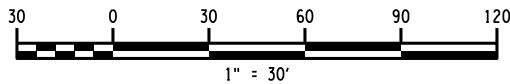

NO.	REVISION	BY	DATE
1			
2			
3			
4			
5			
6			

I, the undersigned, being a duly Licensed Professional Engineer, do hereby certify that I am the author of the design and plan shown on this drawing, and that I am a duly Licensed Professional Engineer in the State of New York, License No. 14614, dated 10/1/09, and that I am duly qualified to perform the services shown on this drawing, and that I am duly qualified to perform the services shown on this drawing, and that I am duly qualified to perform the services shown on this drawing.

**PROJECT CLIENT**  
MIDTOWN REDEVELOPMENT PROJECT  
(FORMER MIDTOWN PLAZA SITE)  
CITY OF ROCHESTER  
DEPARTMENT OF ENVIRONMENTAL SERVICES

**PROJECT TITLE**  
BROAD STREET ONE-WAY CONVERSION

**ISSUED FOR**  
FDR

**DESIGNED BY:**  
BAH

**DRAWN BY:**  
CON

**REVIEWED BY:**  
BRM

**DATE:**  
APRIL 19, 2011

**PROJECT/DRAWING NUMBER**  
210301

**BP-02**

**LABELIA Associates, P.C.**  
300 STATE STREET  
ROCHESTER, NY 14614  
P: (585) 454-6110  
F: (585) 454-3066  
www.labeliaassoc.com  
COPYRIGHT © 2011

PROJECT CLIENT	PROJECT TITLE	ISSUED FOR	DESIGNED BY:	DRAWN BY:	REVIEWED BY:	DATE:
MIDTOWN REDEVELOPMENT PROJECT (FORMER MIDTOWN PLAZA SITE)	BROAD STREET ONE-WAY CONVERSION	FDR	BAH	CON	BRM	APRIL 19, 2011

**PROJECT/DRAWING NUMBER**  
210301

**BP-02**