

Midtown Rising

**Thomas Richards
Corporation Counsel
City of Rochester, New York**



Genesee River

Inner Loop

Main Street

Convention Center

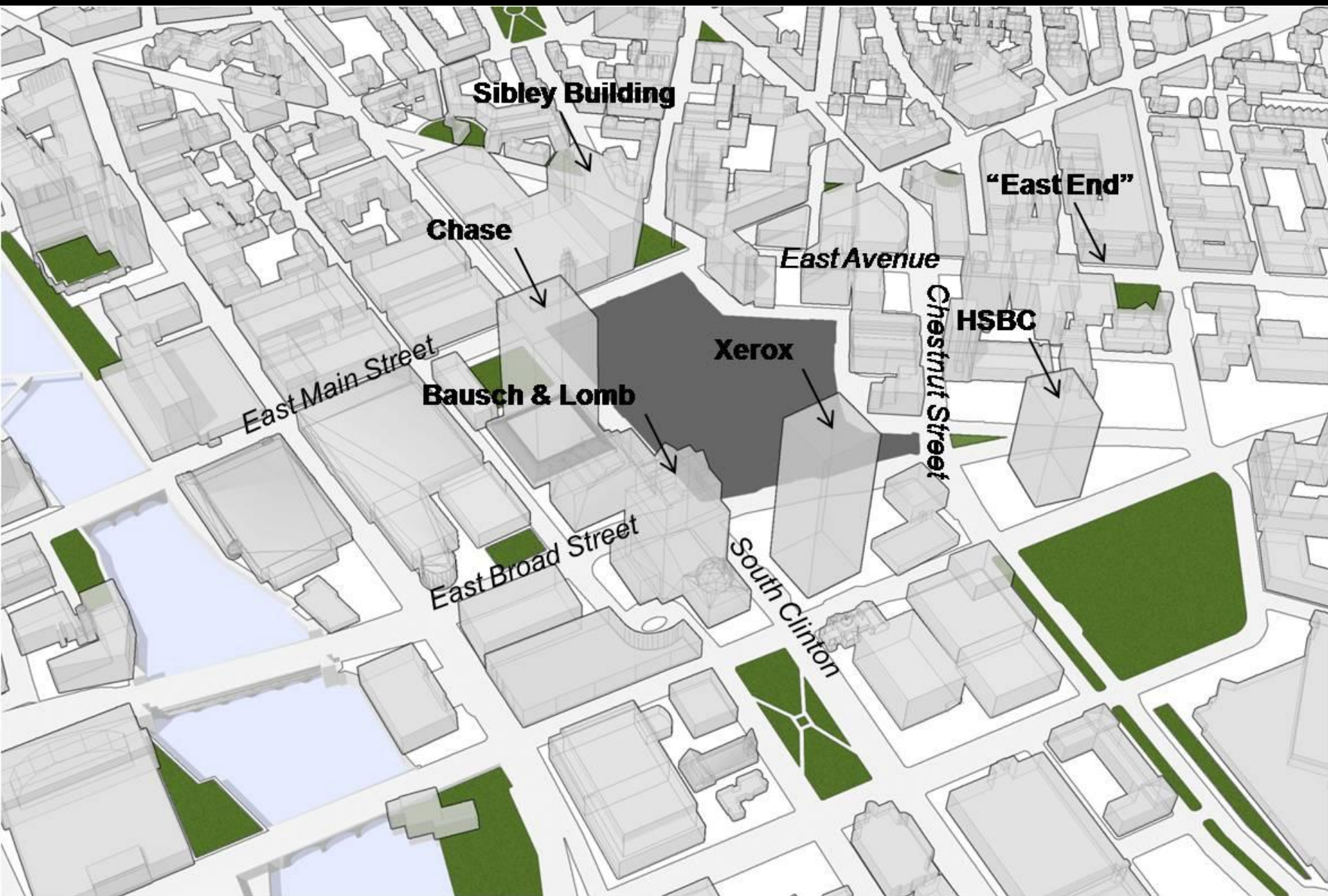

Midtown
Project Area

N

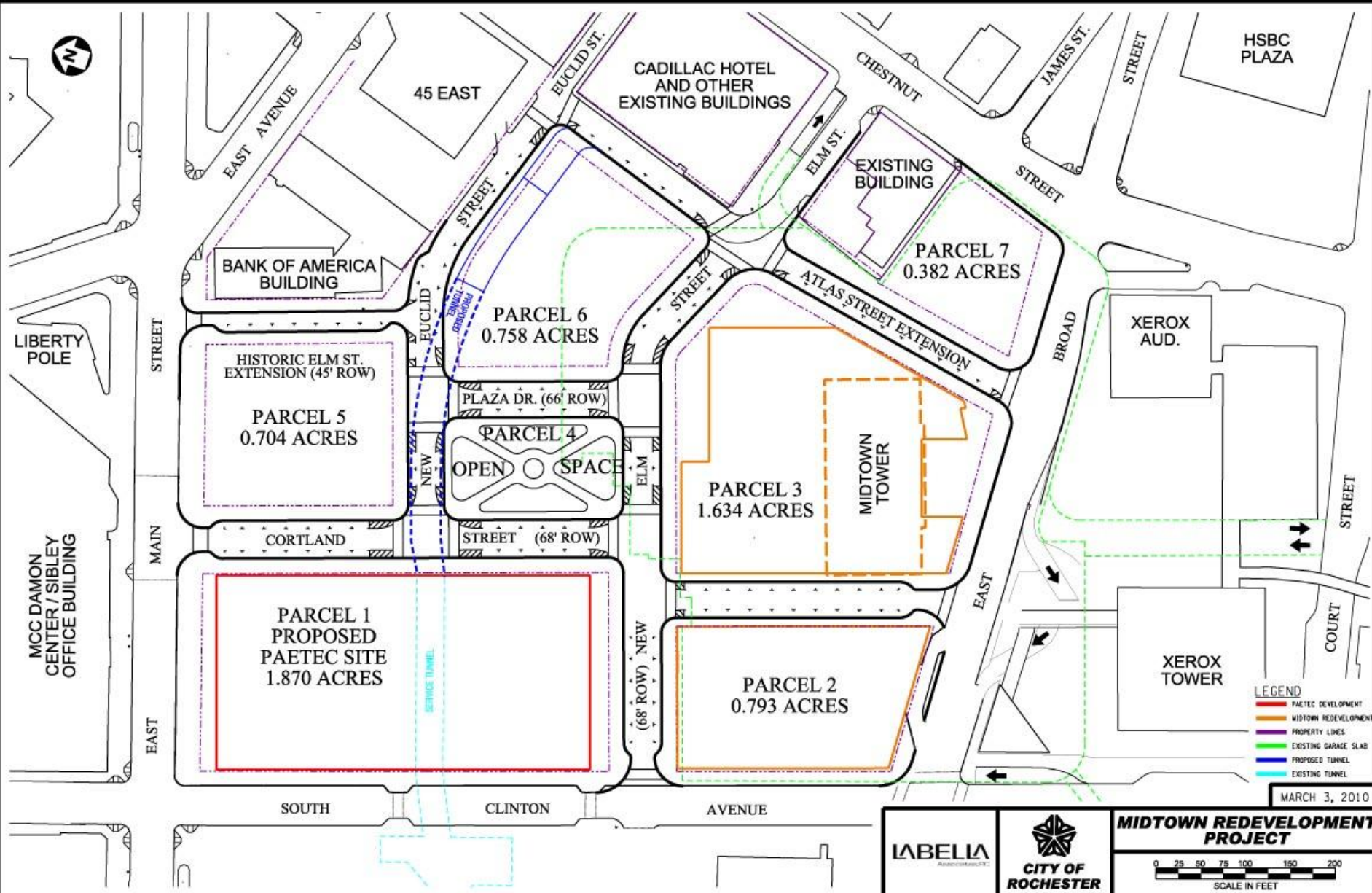



MARCH 3, 2010



CITY OF ROCHESTER

MIDTOWN REDEVELOPMENT PROJECT



SCALE IN FEET

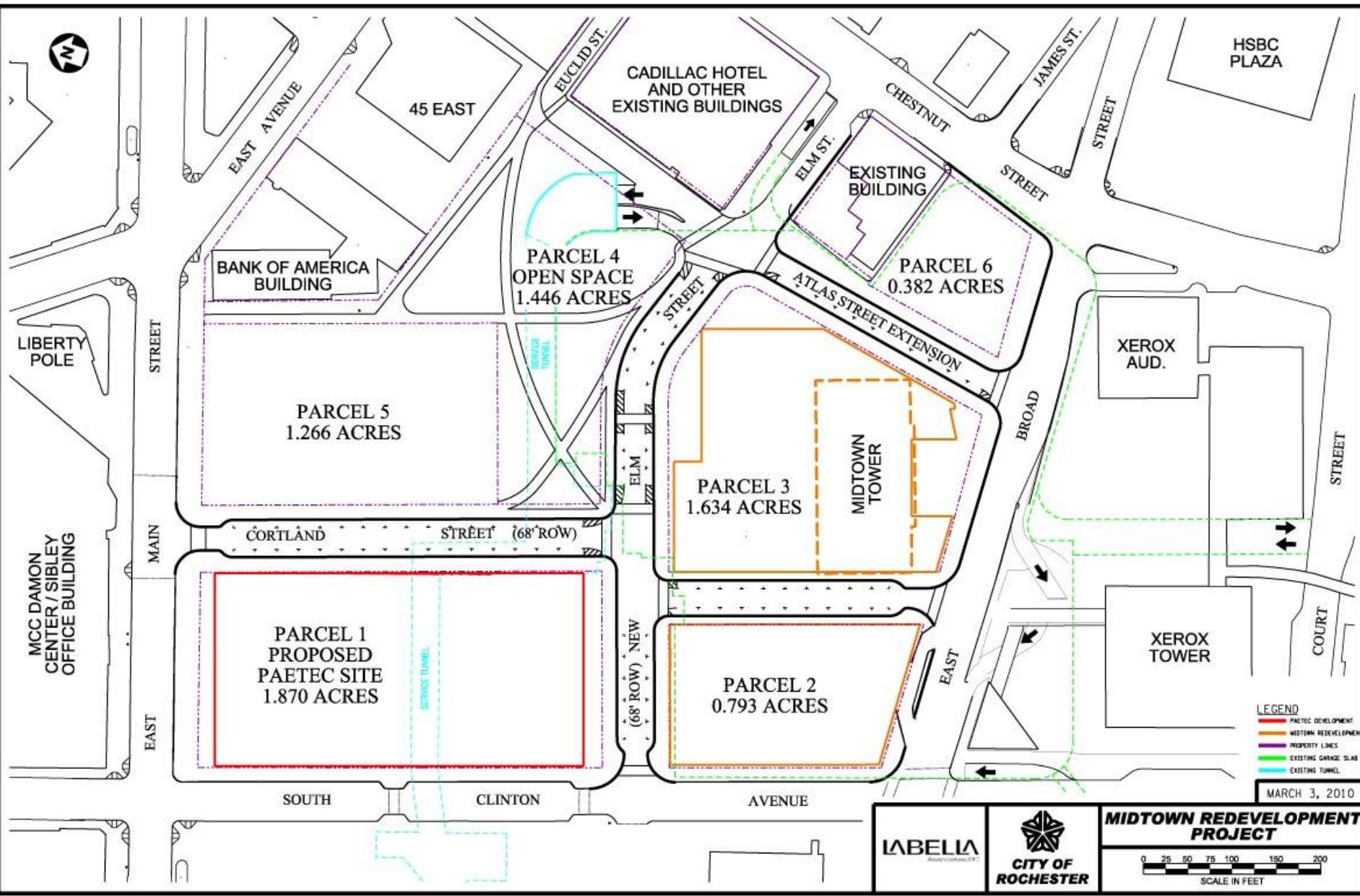

MARCH 3, 2010



LABELIA
ARCHITECTS



**CITY OF
ROCHESTER**

**MIDTOWN REDEVELOPMENT
PROJECT**

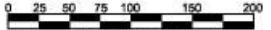

SCALE IN FEET

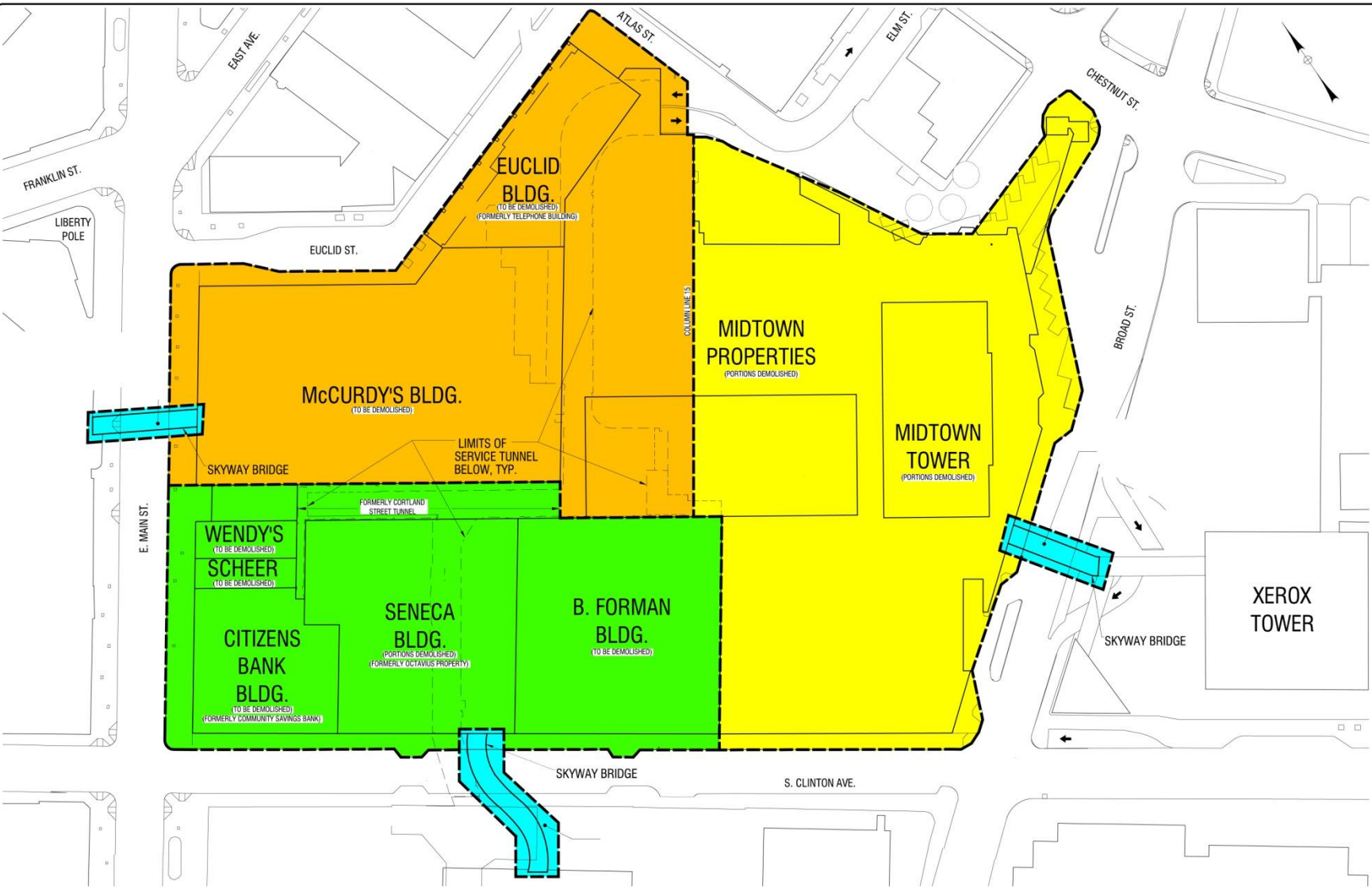

PLAN
SCALE: 1" = 40'

★ THE CONTRACTOR SHALL SUBMIT A SERVICE TUNNEL OPERATIONS STAGING PLAN TO THE CONSTRUCTION MANAGER AND PROJECT ENGINEER FOR REVIEW PRIOR TO BEGINNING PHASE IV DEMOLITION WORK. THE STAGING PLAN SHALL ENSURE THAT DEMOLITION OPERATIONS DO NOT OCCUR OVER PORTIONS OF THE SERVICE TUNNEL DESIGNATED AS OPEN TO TRAFFIC.

NO.	BY	DATE
1		
2		
3		
4		
5		
6		
7		
8		
9		
10		

REVISIONS

ABELLA
Associates, P.C.

300 STATE STREET
ROCHESTER, NY 14614
P: (585) 454-6110
F: (585) 454-3066
www.abellassociates.com

REVISIONS

**MIDTOWN PLAZA - DEMOLITION
& SITE PREPARATION**

EMPIRE STATE DEVELOPMENT
400 ANDREWS STREET SUITE 100
ROCHESTER, NEW YORK 14604

REVISIONS

**DEMOLITION PHASING
PLAN**

DESIGNED BY: [blank]
CHECKED BY: [blank]
DATE: 22 FEBRUARY 2010

CONSTRUCTION

DATE: 22 FEBRUARY 2010

PROJECT DRAWING NUMBER

208699

DP1.00

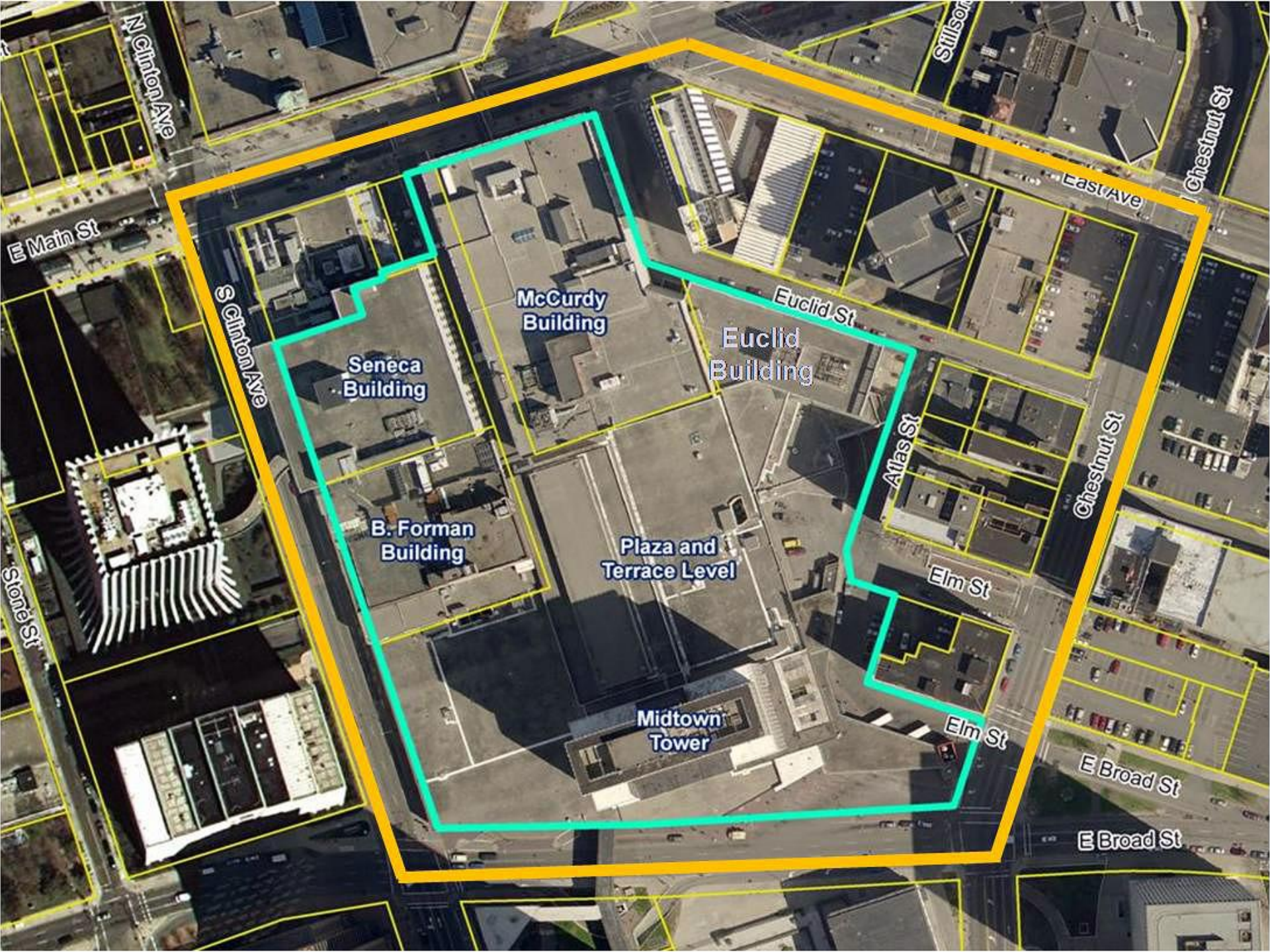
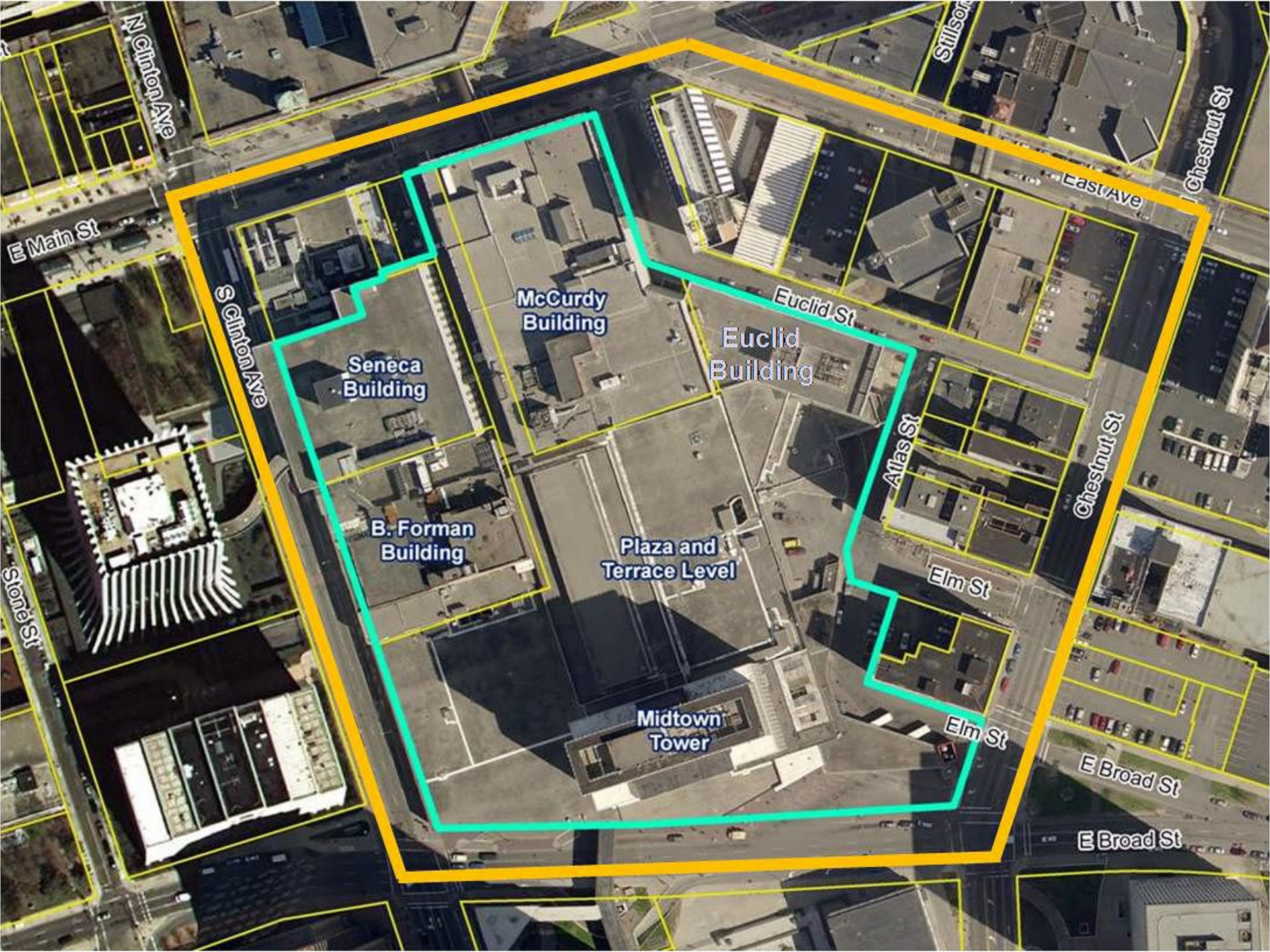



MAIN STREET

PAETEC

HISTORIC ELM STREET

PLAZA DRIVE

ATLAS STREET

NEW ELM STREET

EUCLID STREET

CHESTNUT STREET

EAST AVENUE

BROAD STREET

LINTON AVENUE

