

“Perform”



“Perform” - Character Images



Skyline Park, Denver, CO

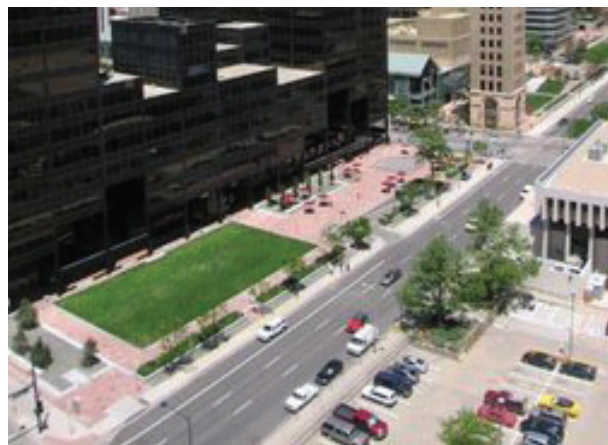

Park, Boston, MA

“Node”



“Node” Character Images



Skyline Park, Denver, CO



Pavilions



Pavilions - Character Images



Riverside,



Plaza Street



Plaza Street - Character Im-



Fillmore Plaza, Denver, CO



Main Street, Greenville, SC



High Falls, Rochester, NY

Seat wall - Character Images



Architecture and Dynamics - F. Ullmann (Springer, 2011)



Thomas Jefferson University, Philadelphia, PA



Central Wharf Plaza, Boston, MA



Pedestrian Street

Cortland Street extension is proposed as a pedestrian only right of way. The Pedestrian Street will be flanked by two new parcels, one of which has already committed to providing ground-floor retail experiences. Directly off Broad Street, and leading to the interior of the site, this has the potential to be an active and programmed outdoor space. Events, sidewalk sales, outdoor dining, and other street activity could occur in this zone. Site design for a pedestrian street along this corridor suggests a flexible arrangement with wide sidewalks along the building face with room for both programming and pedestrian movement, center unit paving with movable seating. Due to minimal soil depth over the garage, sculptural vine trellises replace the use of trees. An playful interactive space is proposed for central area of the pedestrian street.

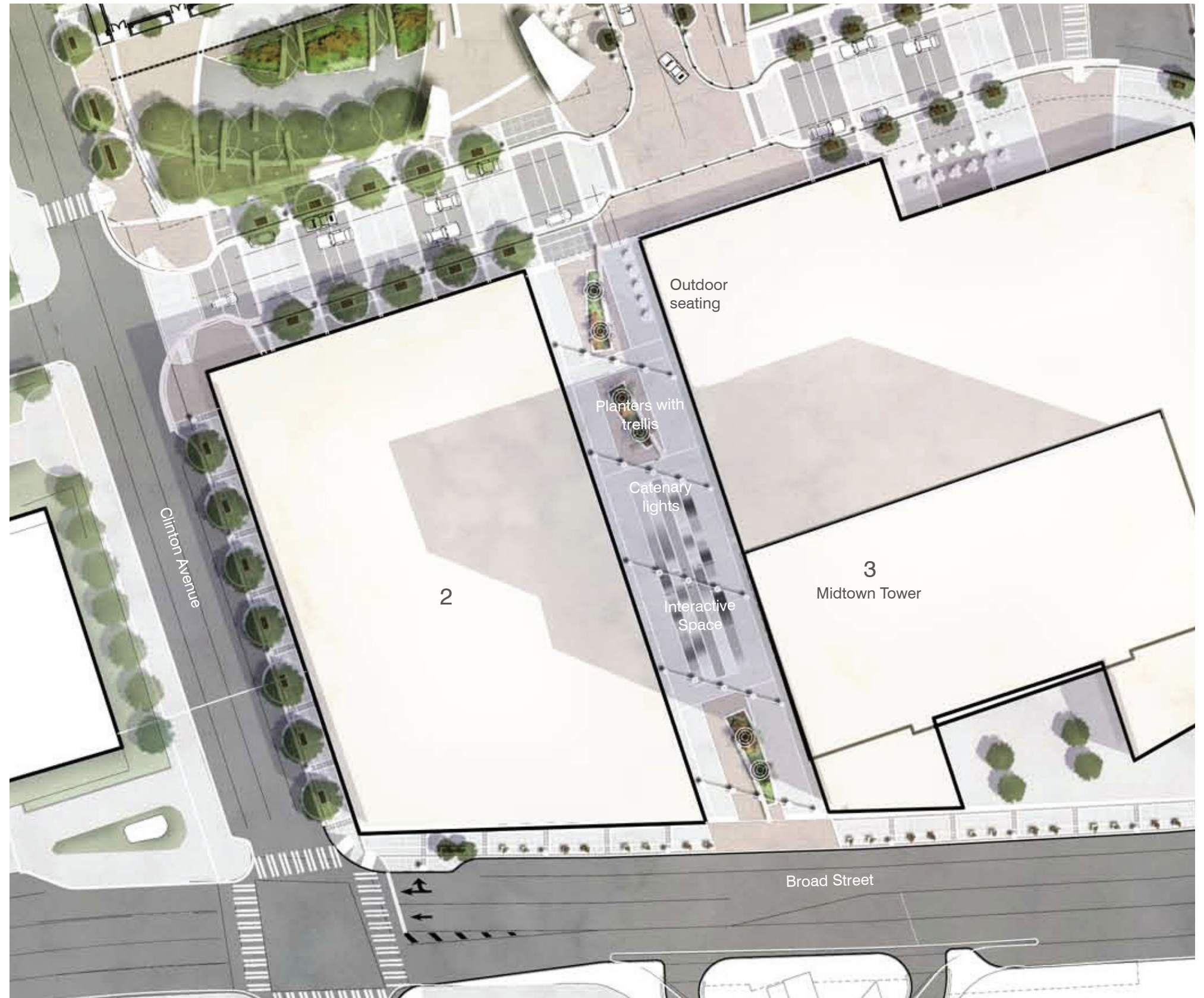

Pedestrian Street



Pedestrian Street - Character Images



Pedestrian Street typical section



Mint Plaza, San Francisco, CA

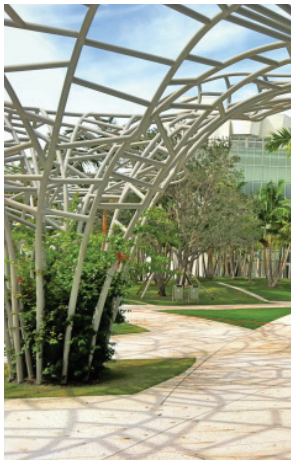

Soudscape, Miami, FL



Interactive Space - Character Images

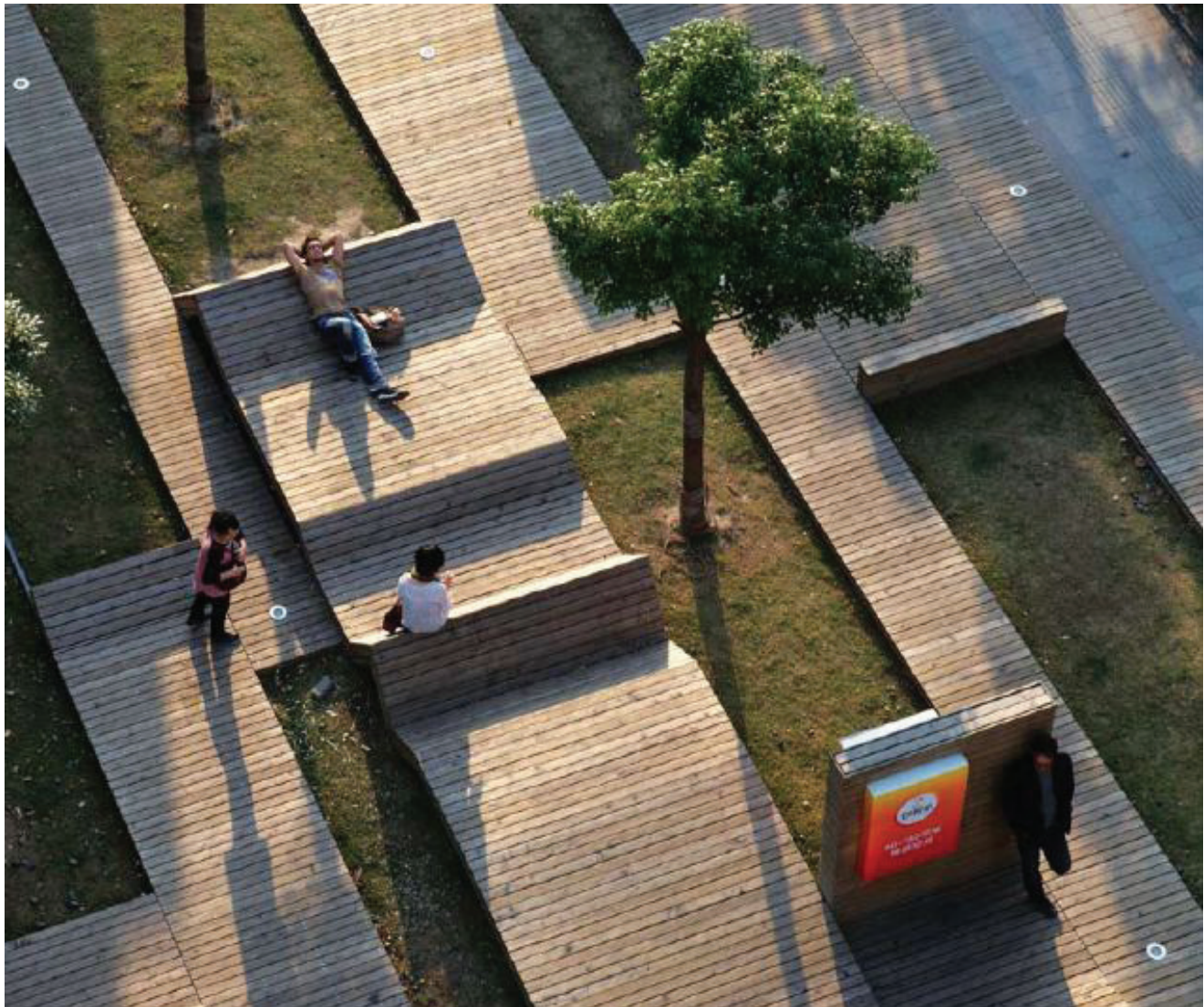

Architecture and Dynamics - F. Ullmann (Springer, 2011)



Wave Deck, Toronto, CA

