

MULTI-LANE
2 WAY
ROADWAY

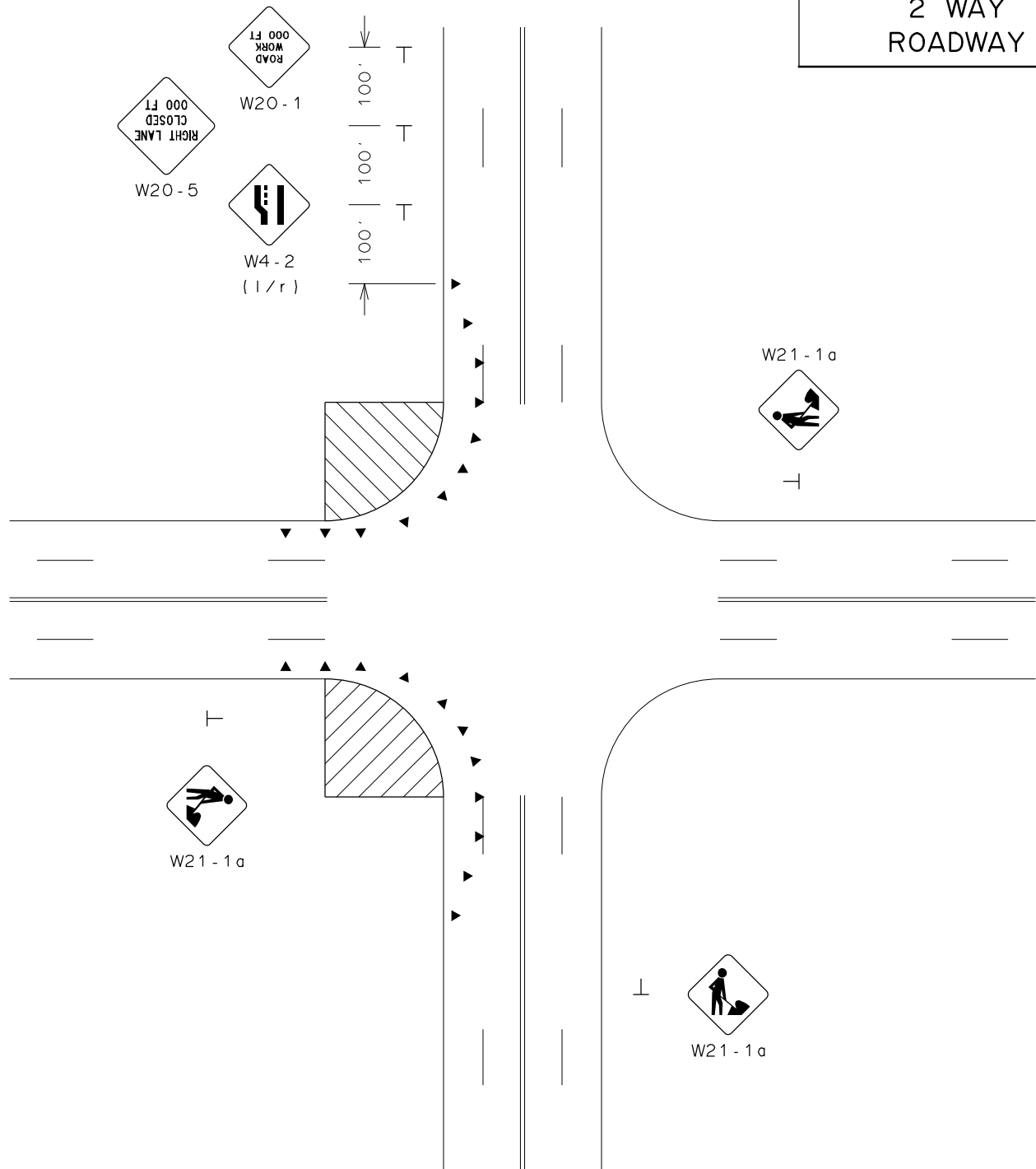

NOTES :

1. TAPER LENGTH PER NATIONAL MUCTD TABLE 6C-4.
2. MAINTAIN MINIMUM 10 FEET WIDE DRIVING LANE.

CITY OF ROCHESTER

MAINTENANCE AND
PROTECTION OF
TRAFFIC - MPT-3

ISSUED	10-22-01	NON-STANDARD DWG.NO.S619-5
REVISED	1-1-17	