

City of Rochester

Pedestrian Safety Action Plan





Public Meeting
Tuesday November 17, 2020
5:00 pm – 6:00 pm

Due to current statewide COVID-19 health emergency restrictions that forbid public assembly, all project meetings and public outreach will be conducted via video conference until further notice.



Zoom Webinar Format

- Attendance: Please use the “chat”  feature to provide your name and address.
- Questions: Meeting participants will be muted during the presentation. Questions will be addressed at the end of the presentation.
 - Meeting participants on a computer can type Alt +Y (*or Option+Y if using a Mac*) to “raise your hand” to ask a question or simply click on the hand symbol  on your screen.
 - Meeting participants on a phone can dial *9 to “raise your hand” to ask a question.



Agenda

- I. Introductions
- II. Project Overview
- III. Unsignalized Crosswalks
- IV. Signalized Crosswalks
- V. NYSDOT PSAP Locations
- VI. Maintenance and Protection of Traffic
- VII. Project Schedule
- VIII. Questions and Answers

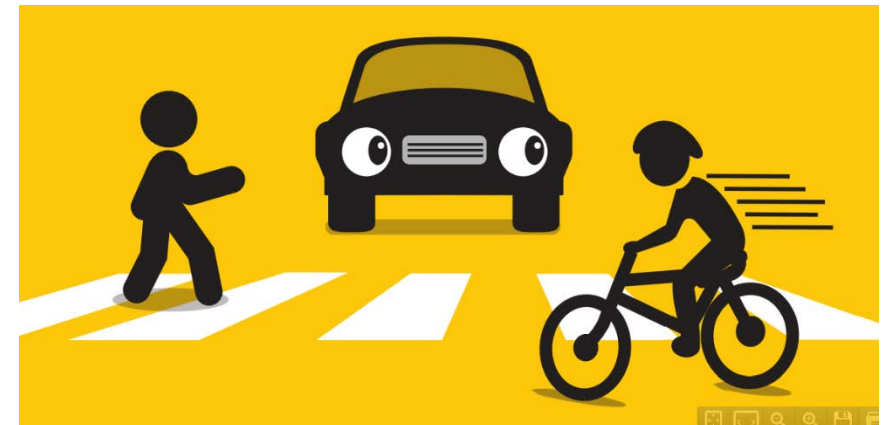
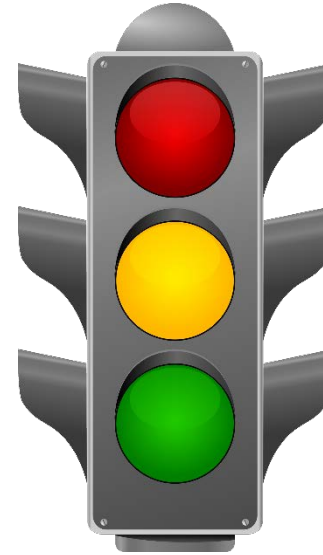

I. Introductions

- Darin Ramsay – City of Rochester – Assistant Transportation Specialist
- Seth Kaeuper – C&S Companies – Project Manager
- Dan Borcz – C&S Companies – Project Engineer
- Tom Polech – Monroe County DOT
- Frank DiCostanzo - NYSDOT
- Erik Frisch – City of Rochester – Manager of Special Projects



II. Project Overview

- Unsignalized Crossings – 94 total locations
 - Basic Package
 - Rectangular Rapid Flashing Beacon (RRFB)
 - Raised Crosswalks
 - Curb Bumpouts and Median
- Signalized Crossings – 99 total locations
 - Leading Pedestrian Interval (LPI)
 - Reflective Backplates
- Monroe County DOT Pedestrian Safety Action Plan
- New York State DOT Pedestrian Safety Action Plan



II. Project Overview – Funding

- 100% Federal Highway Safety Improvement Program Funding
- Administered by NYSDOT
- State priority
- City of Rochester is one of the state's 'Focus Communities'
 - High concentration of pedestrian activity
 - Significant number of collisions
- Project budget: \$1,996,000 for construction



IIIa. Unsignalized Crosswalks – Basic Package

- 77 crossings
- Double Posted Signs
- Painted Crosswalks
- Reflective strips
- Advanced postings 250-300' in advance of the crosswalk



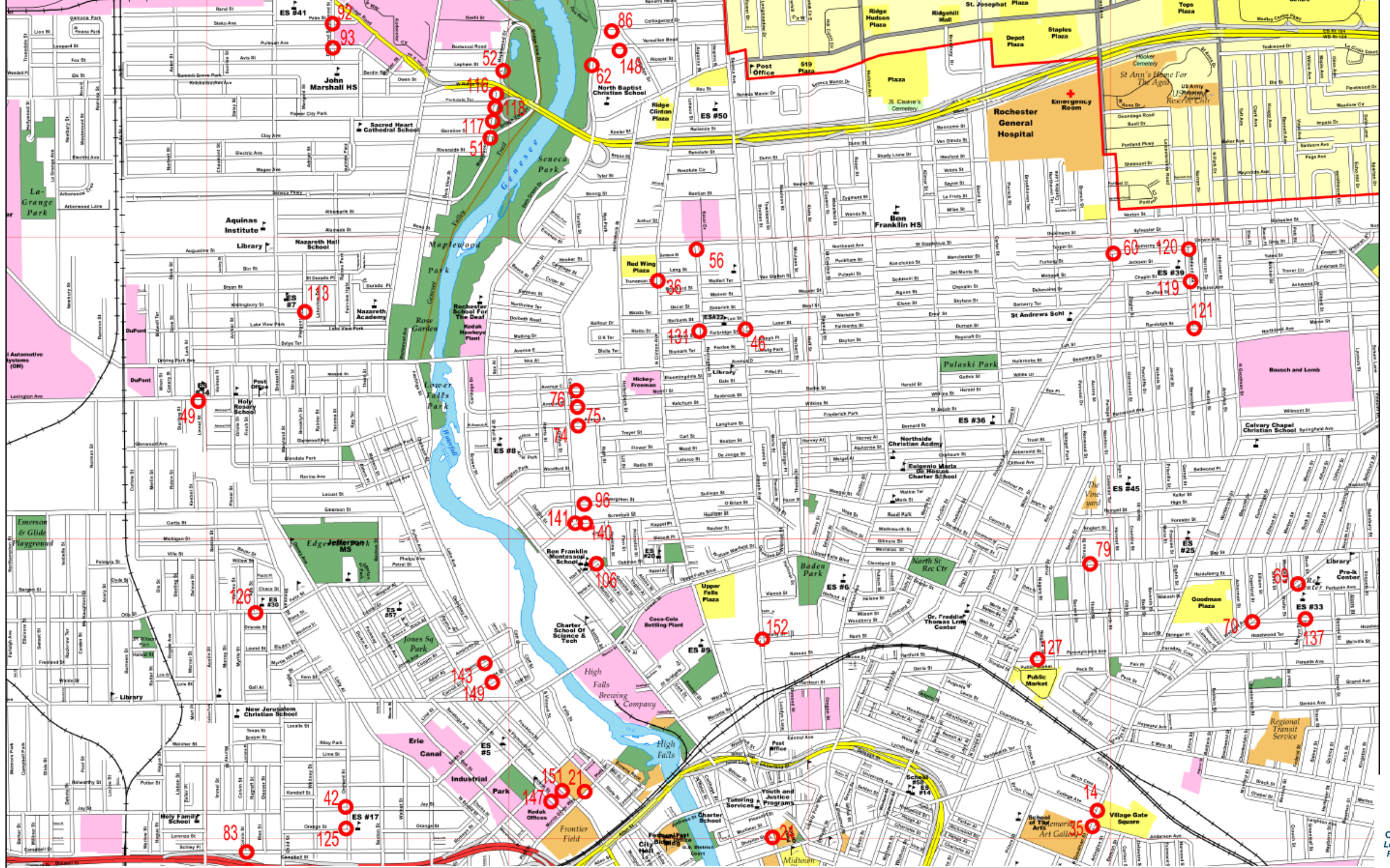

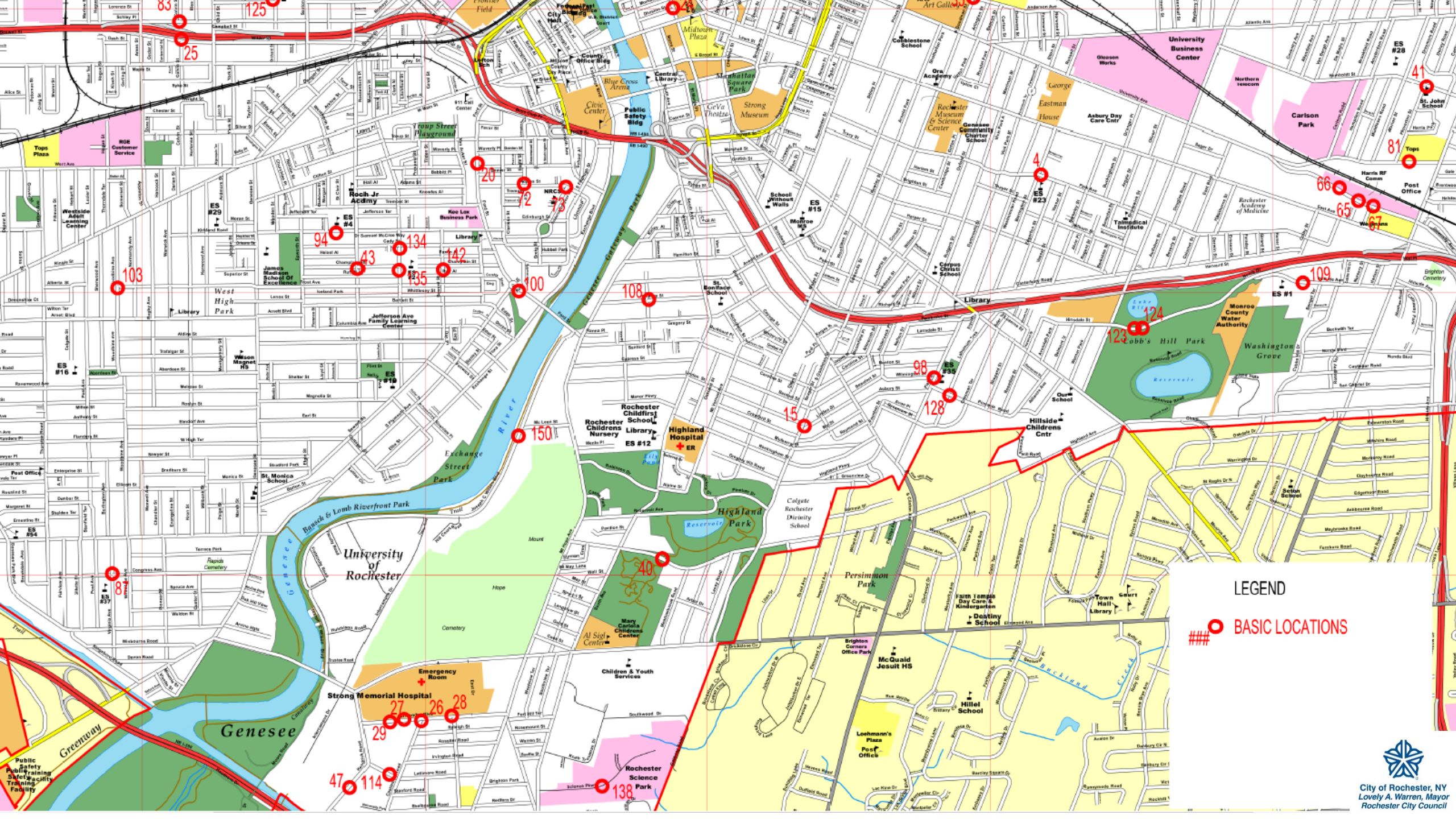

LEGEND

○ BASIC LOCATIONS



City of Rochester, NY
Lovely A. Warren, Mayor
Rochester City Council

IIIb. Unsignalized Crosswalks – RRFB

- 17 Locations
- Solar powered
- Advance postings
- Double posted
- Reflective strips





IIc. Unsignalized Crosswalks – Raised Crosswalks

- 1 location
- With RRFB



Flower City Park at Raines Park



IIId. Unsignalized Crosswalks – Curb Bumpouts

- 5 Locations
- Basic Package at 2
- RRFB at 3



Dewey Ave at Lake View Pk – Clifford Ave at El Camino Trail – Joseph Ave at Wilkins St

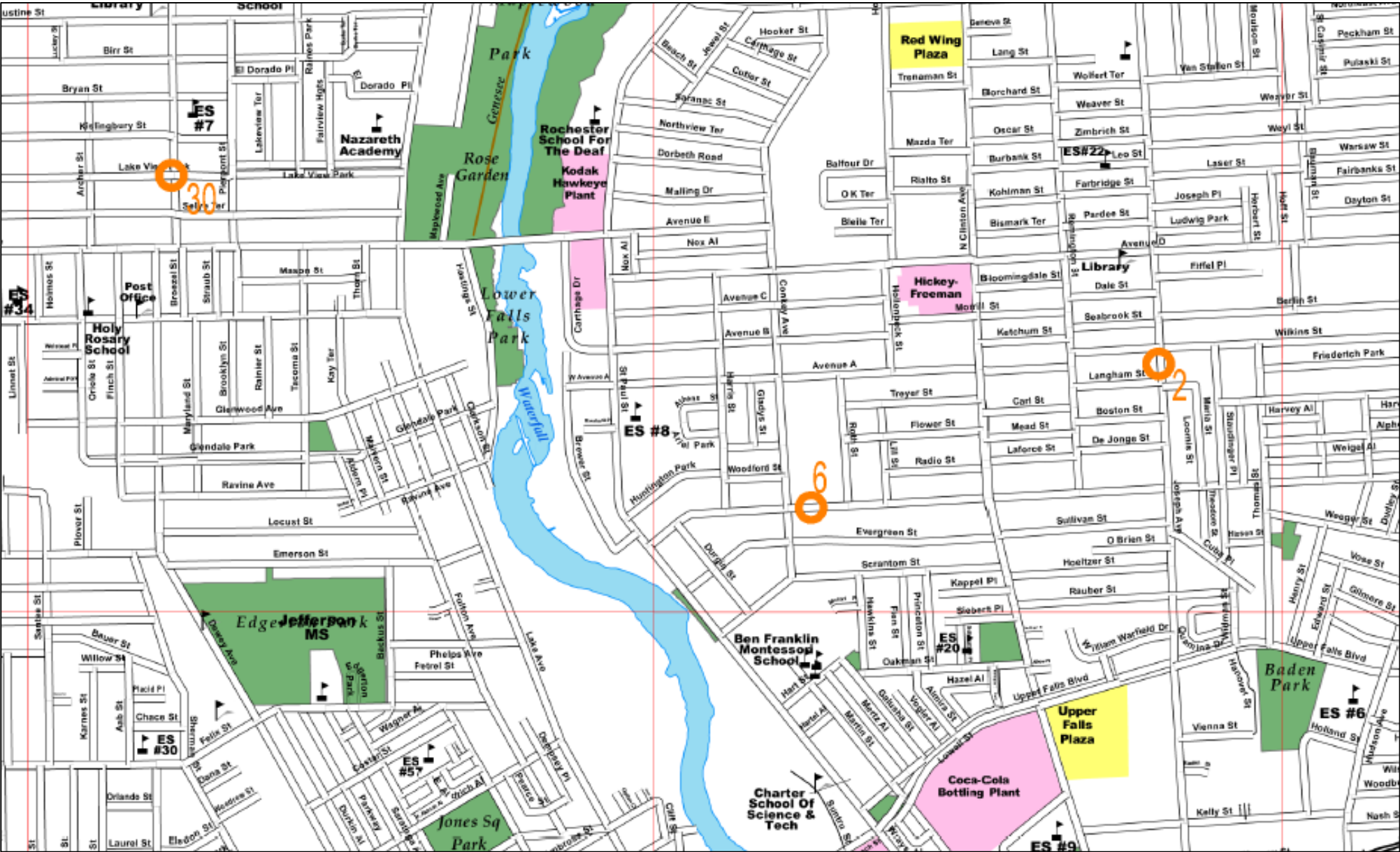

Jefferson Ave at Flint St

South Ave at Sanford/Caroline St

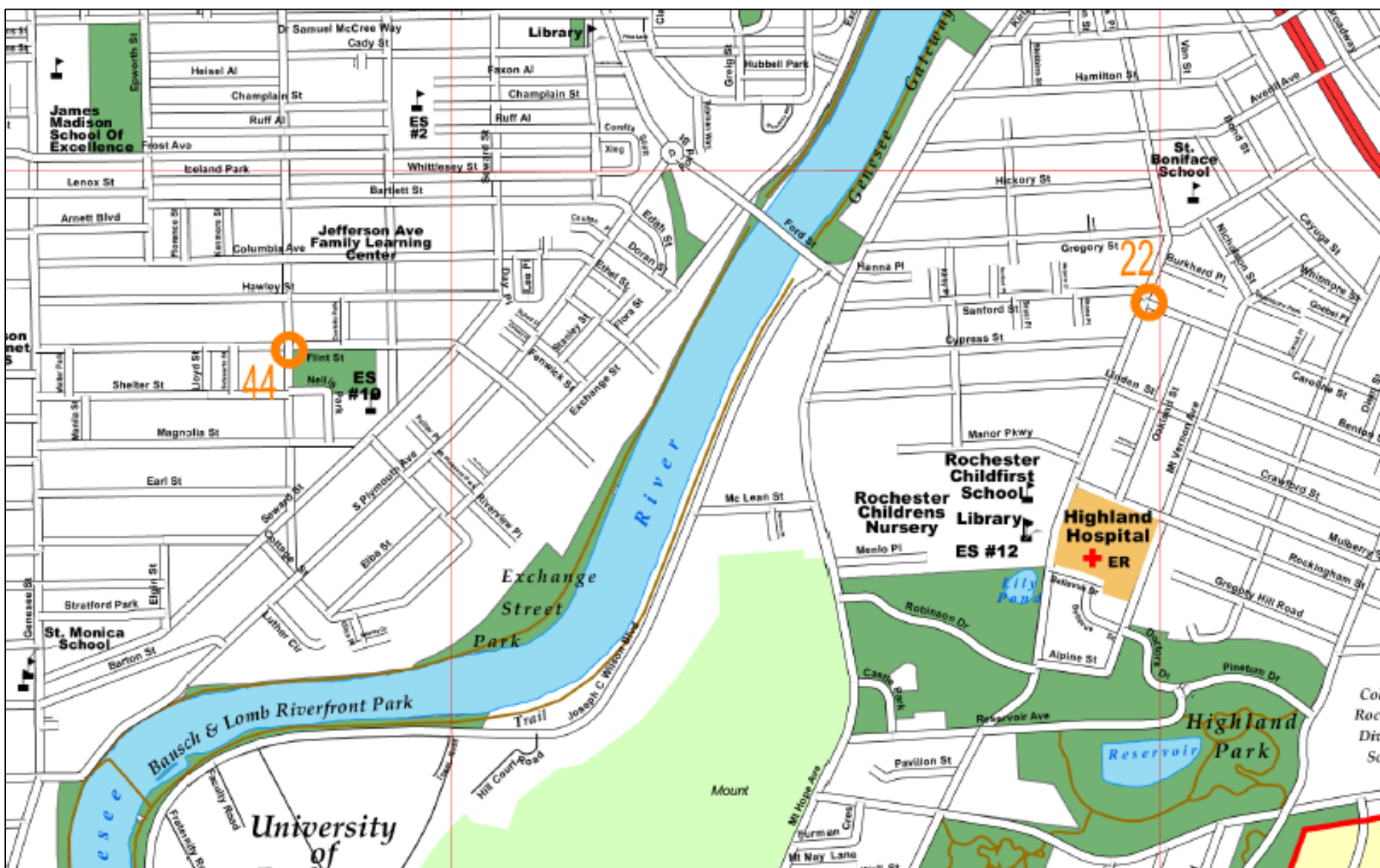

Bump Out 1: Clifford Avenue at El Camino Trail

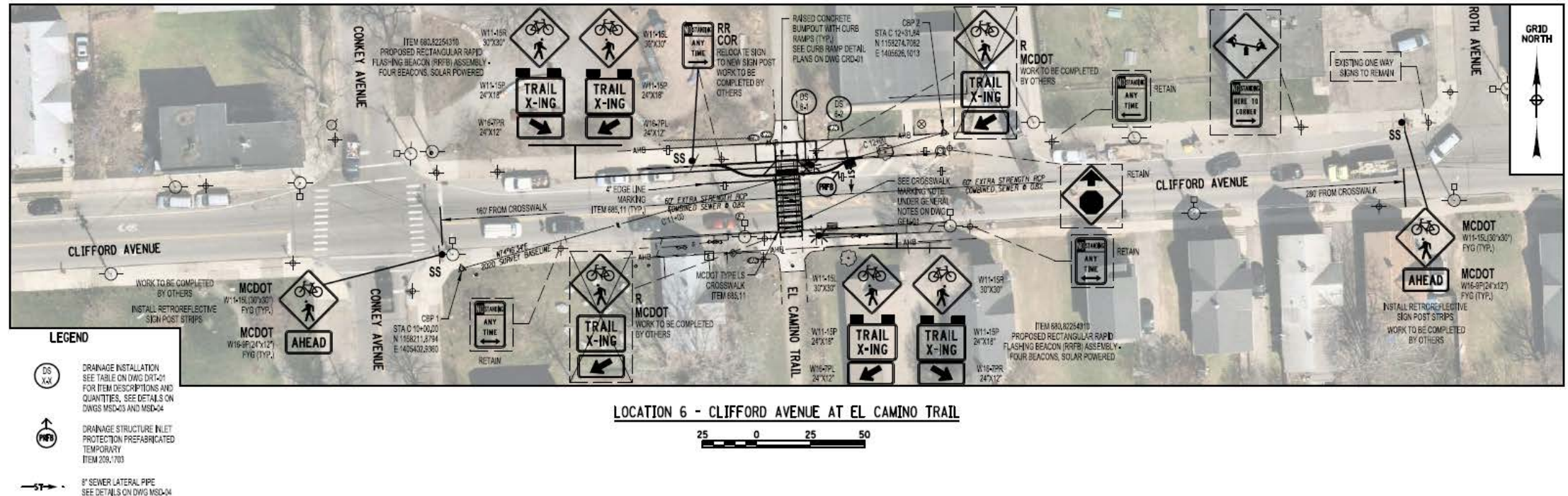

- Bumpout will decrease crossing width by 6 feet, from 32 feet to 26 feet.
- RRFBs included at this location



Bump Out 2: Joseph Avenue at Wilkins Street

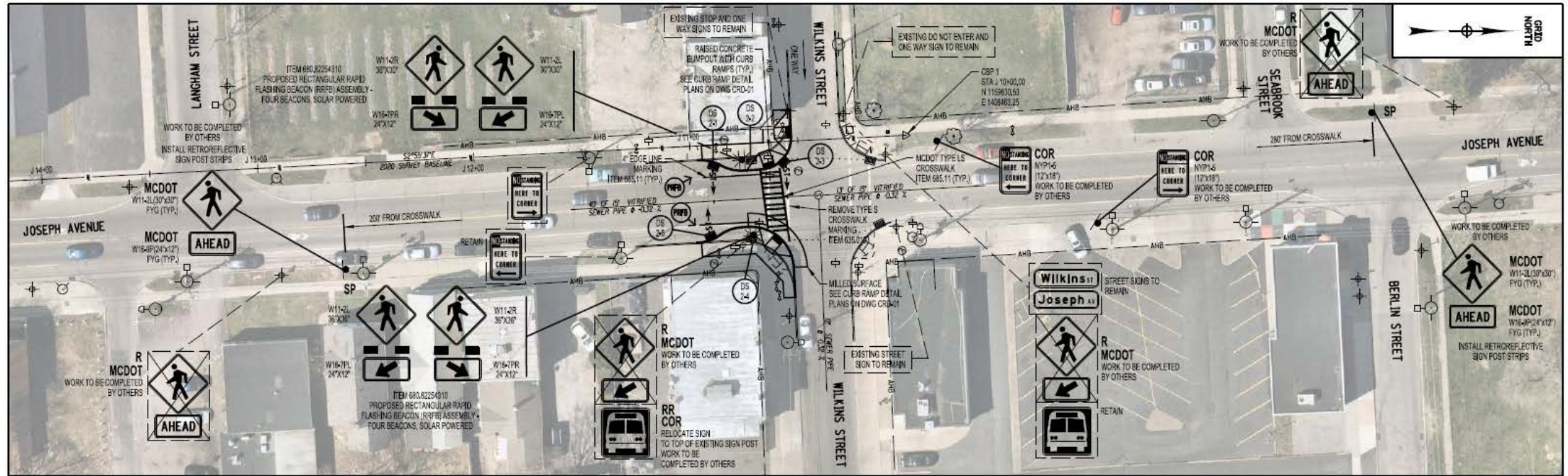

LOCATION 2 - JOSEPH AVENUE AT WILKINS STREET

- Bumpouts will decrease crossing width by 12 feet, from 38 feet to 26 feet.
- RRFBs included at this location



Bump Out 3: Dewey Avenue at Lake View Park

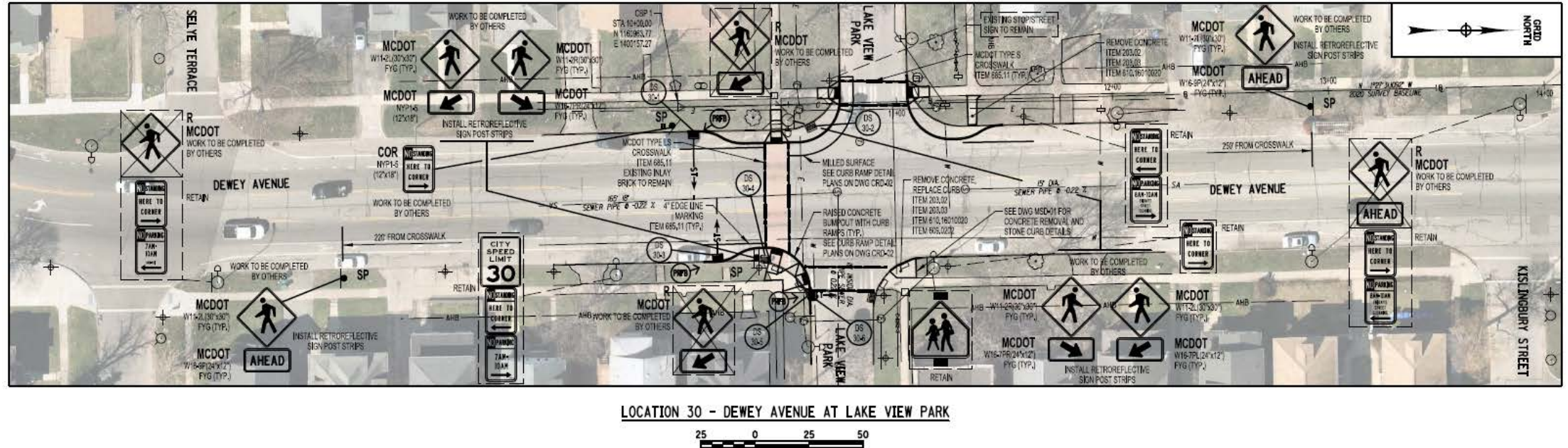

- Bumpouts will decrease crossing width by 12 feet, from 48 feet to 36 feet.
- Basic Package included at this location



Bump Out 4: Jefferson Avenue at Flint Street

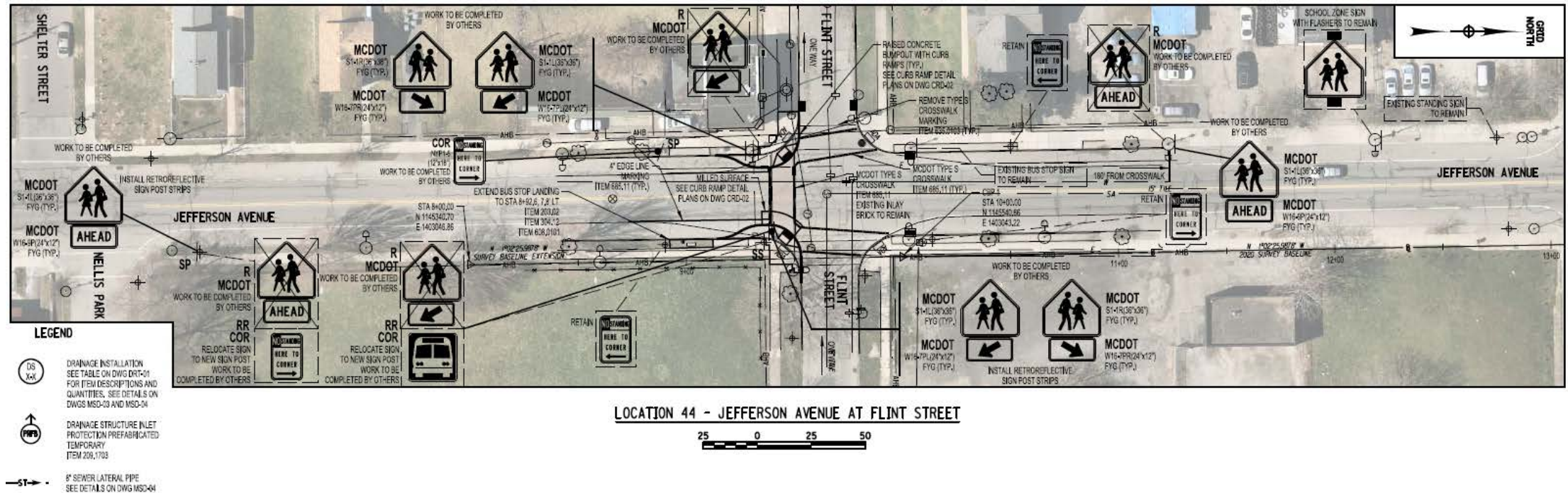

- Bumpouts will decrease crossing width by 12 feet, from 38 feet to 26 feet.
- Basic Package included at this location



Bump Out 5: South Avenue at Sanford Street

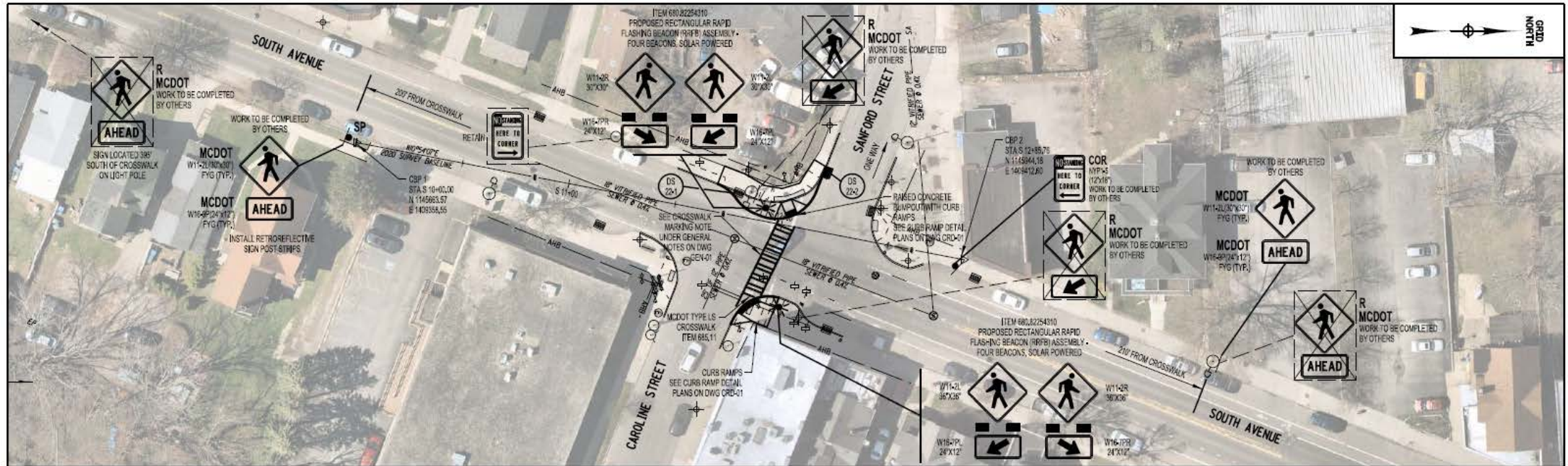

LOCATION 22 - SOUTH AVENUE AT CAROLINE STREET



- Bumpout will decrease crossing width by 6 feet, from 40 feet to 34 feet.
- RRFBs included at this location



IIIe. Unsignalized Crosswalks – Median Island

- 1 location
- RRFB included



Pedestrian Island: E. Main Street at YMCA



Pedestrian Island: E. Main Street at YMCA

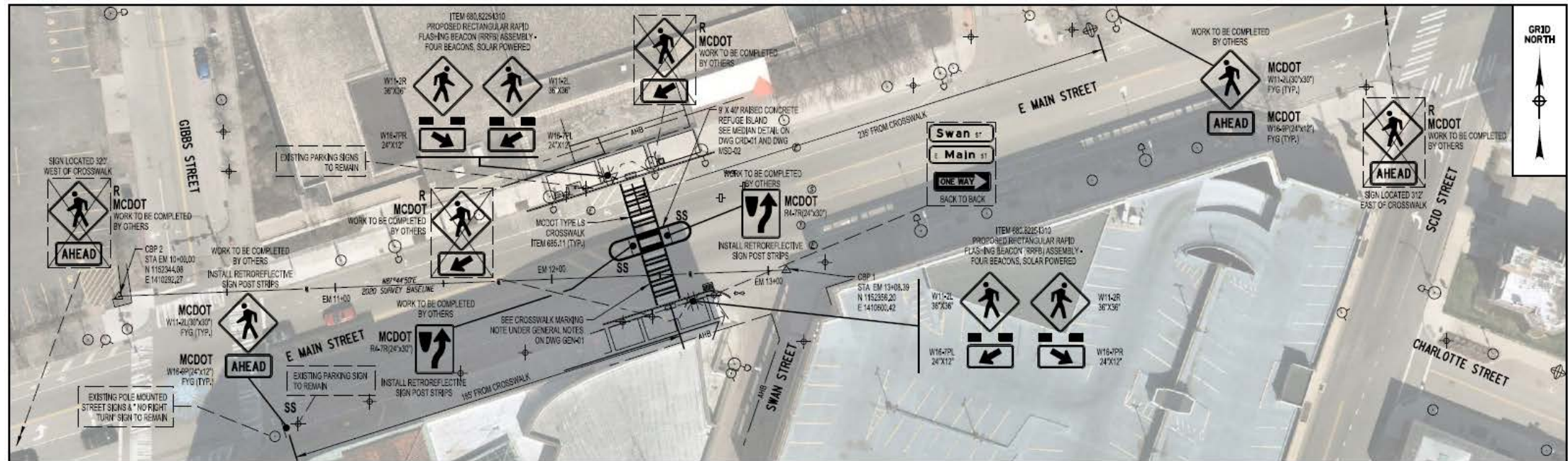

LOCATION 1 - MIDBLOCK AT E MAIN STREET, 50' WEST OF SWAN STREET



- Median Island will create two smaller roads to cross.
- RRFBs included at this location

IVa. Signalized Crosswalks – Reflective Backplates

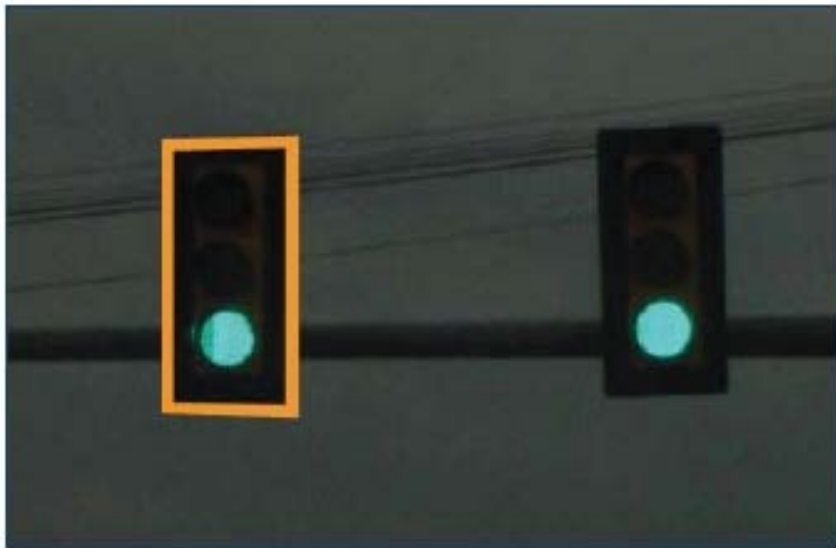

79 Locations



IVb. Signalized Crosswalks – Lead Ped Interval

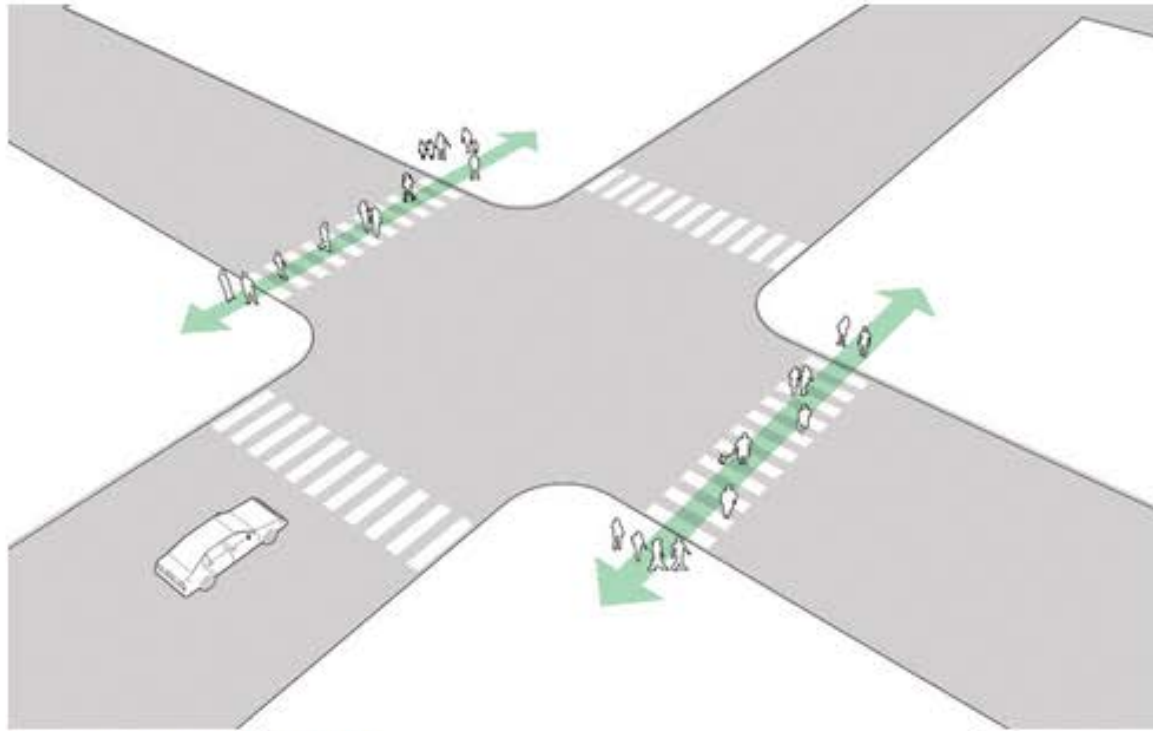

Phase 1: Pedestrians only

Pedestrians are given a minimum 3–7 second head start entering the intersection.

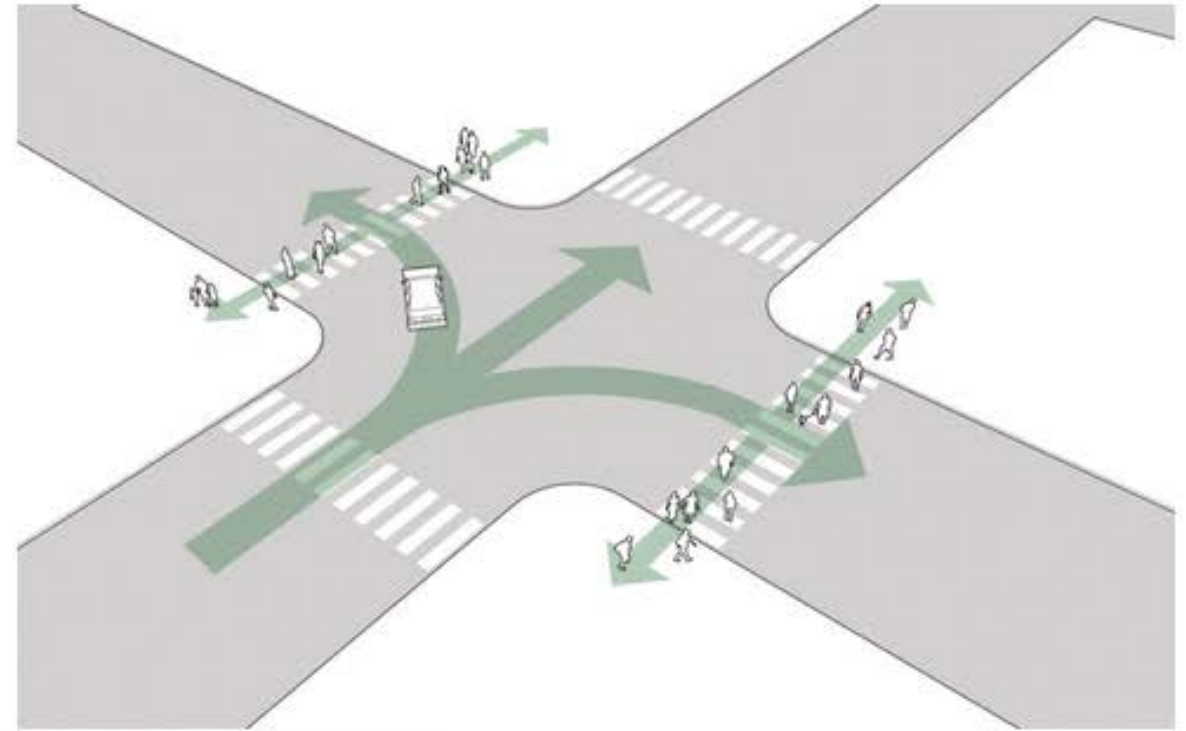

Phase 2: Pedestrians and cars

Through and turning traffic are given the green light. Turning traffic yields to pedestrians already in the crosswalk.

57 Locations



Center City signalized locations

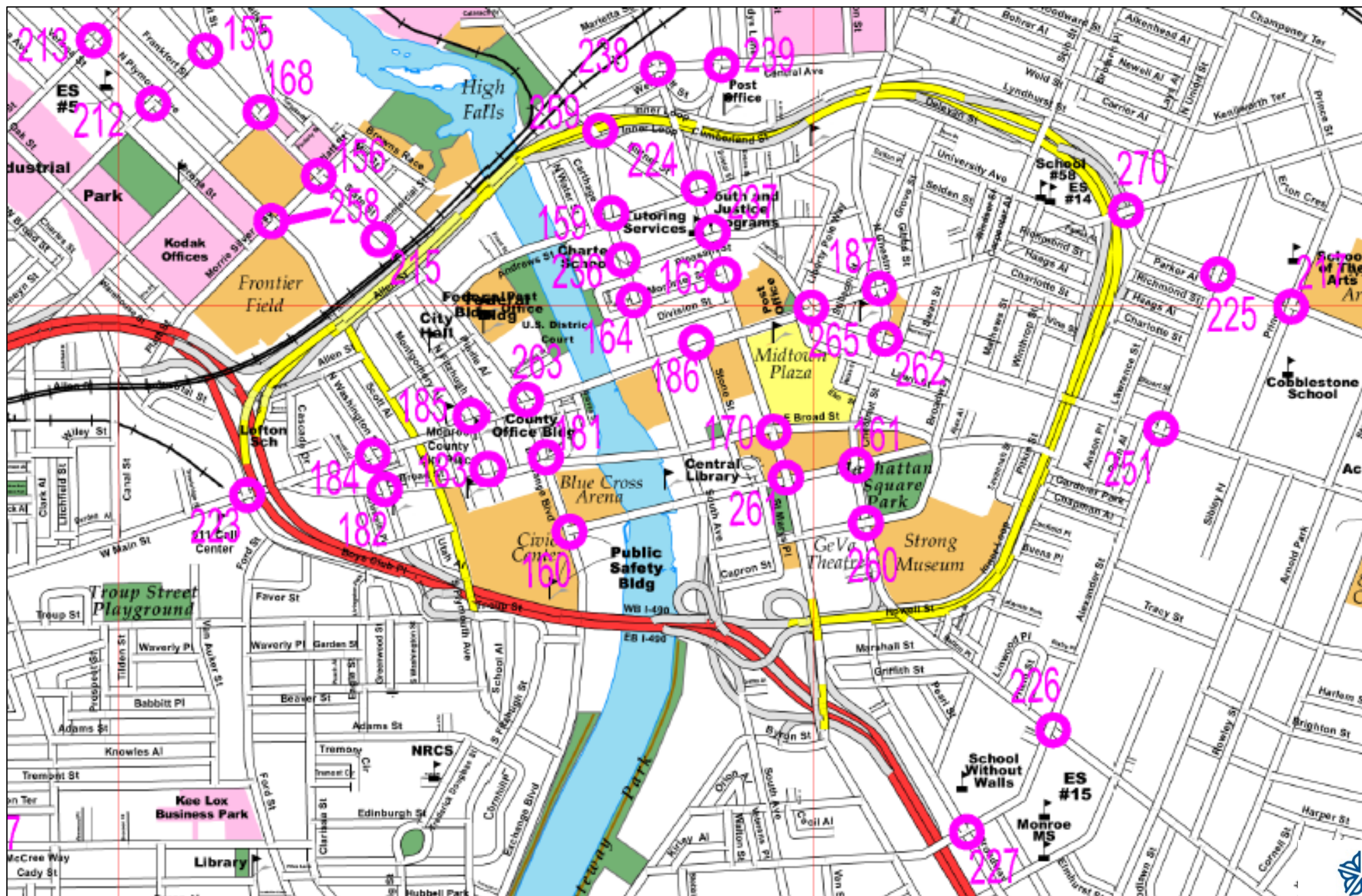

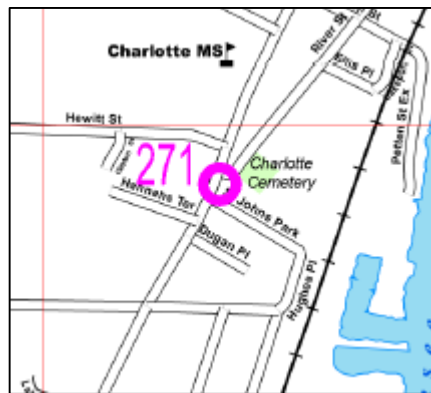
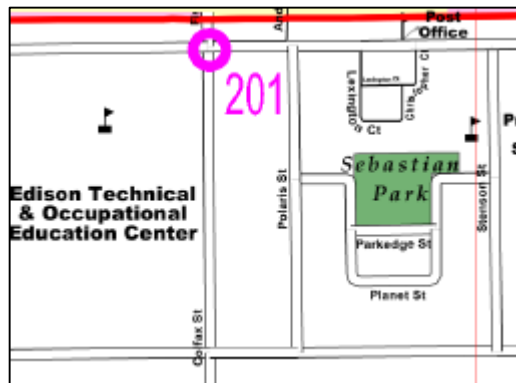
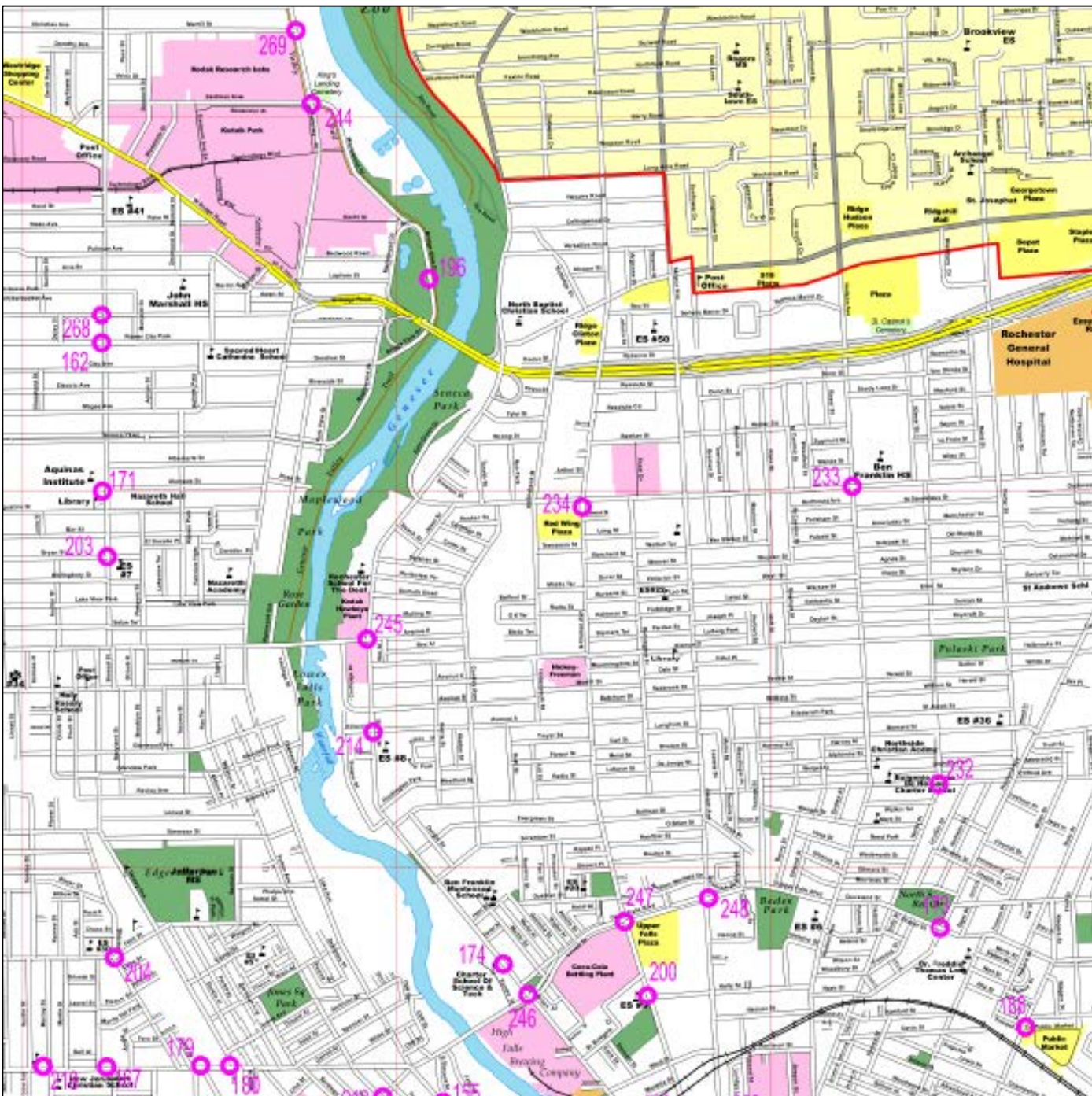

Northwest Quadrant Signalized Locations



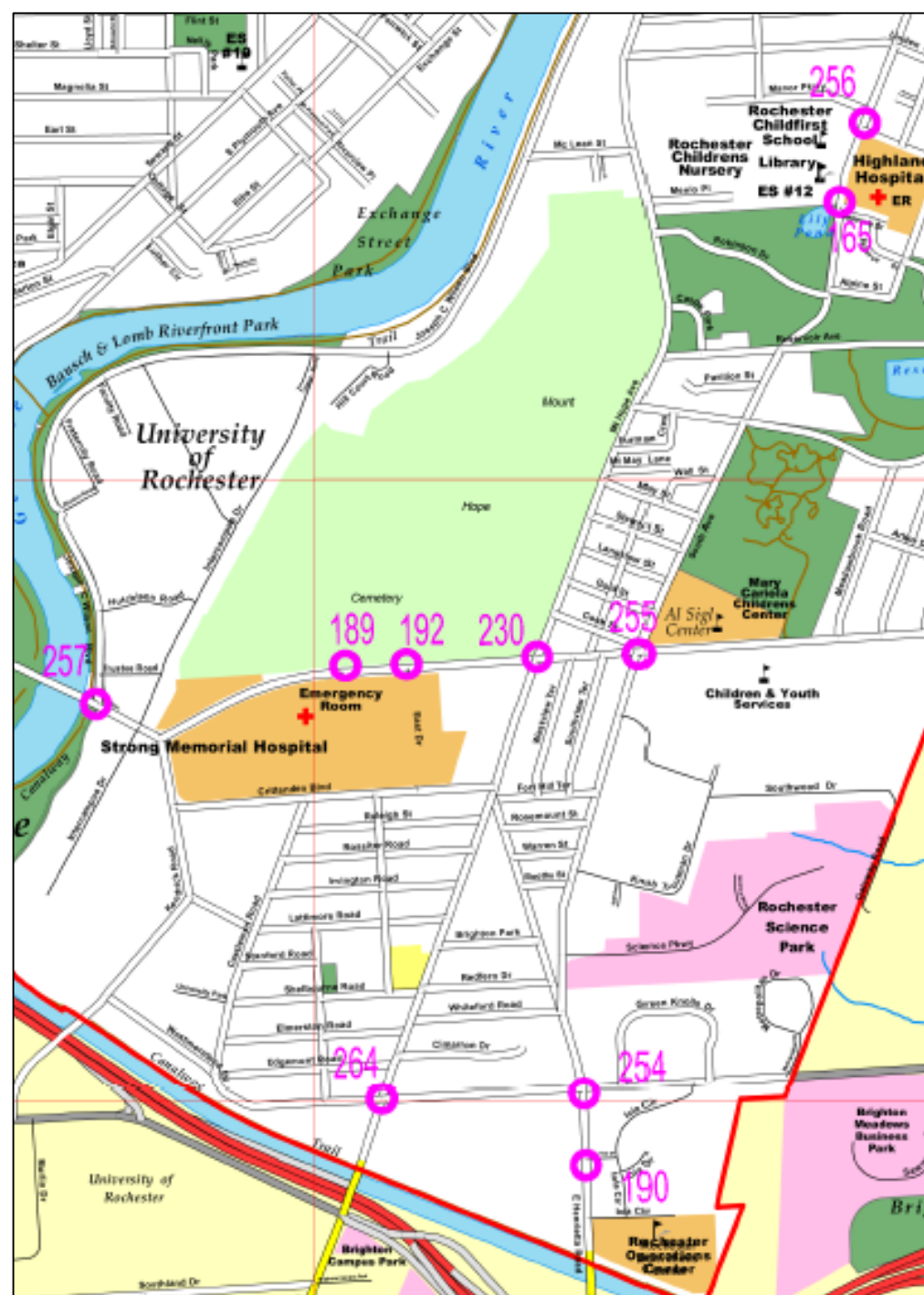
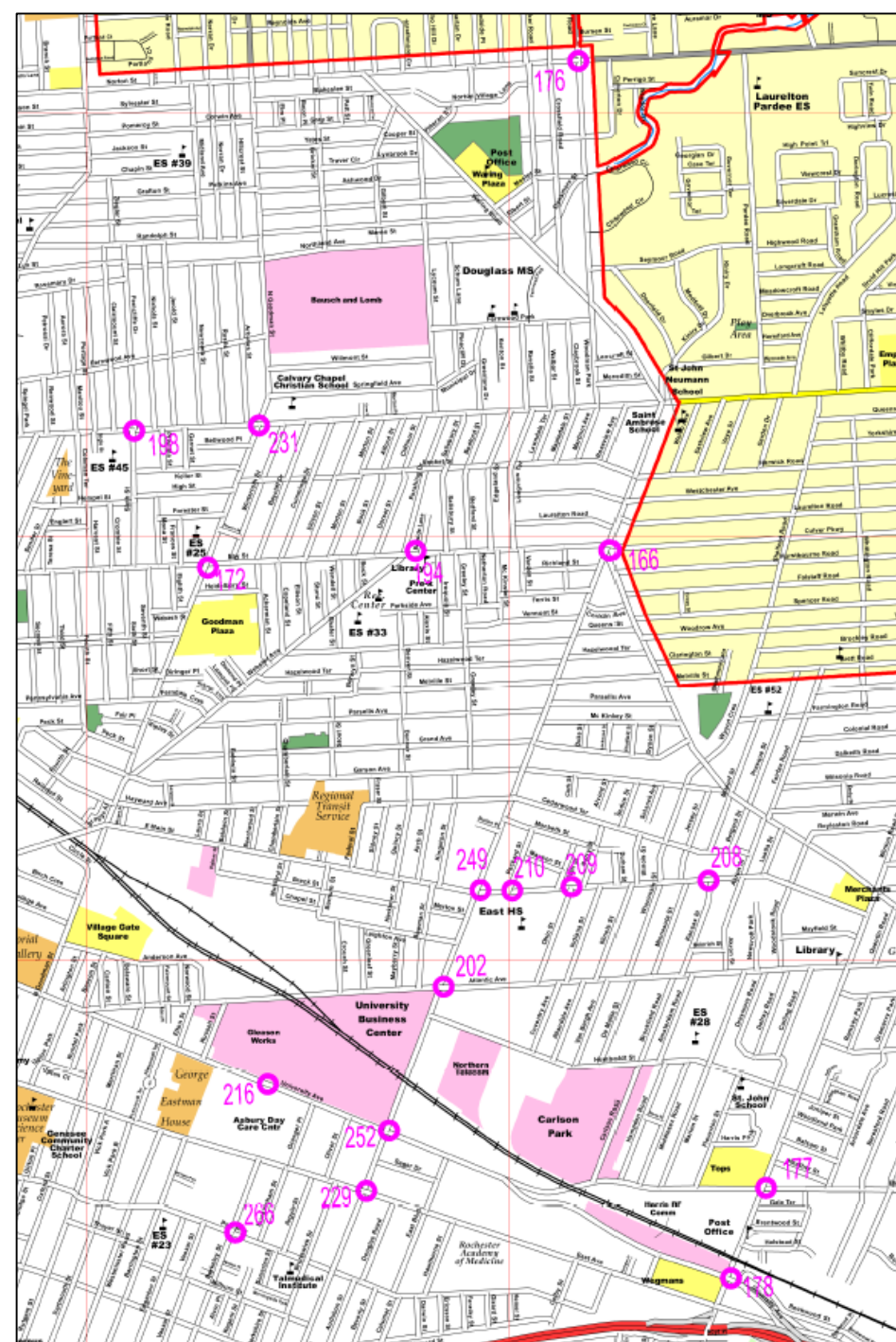

Northeast and Southeast Quadrants Signalized Locations

Southwest Quadrant Signalized Locations

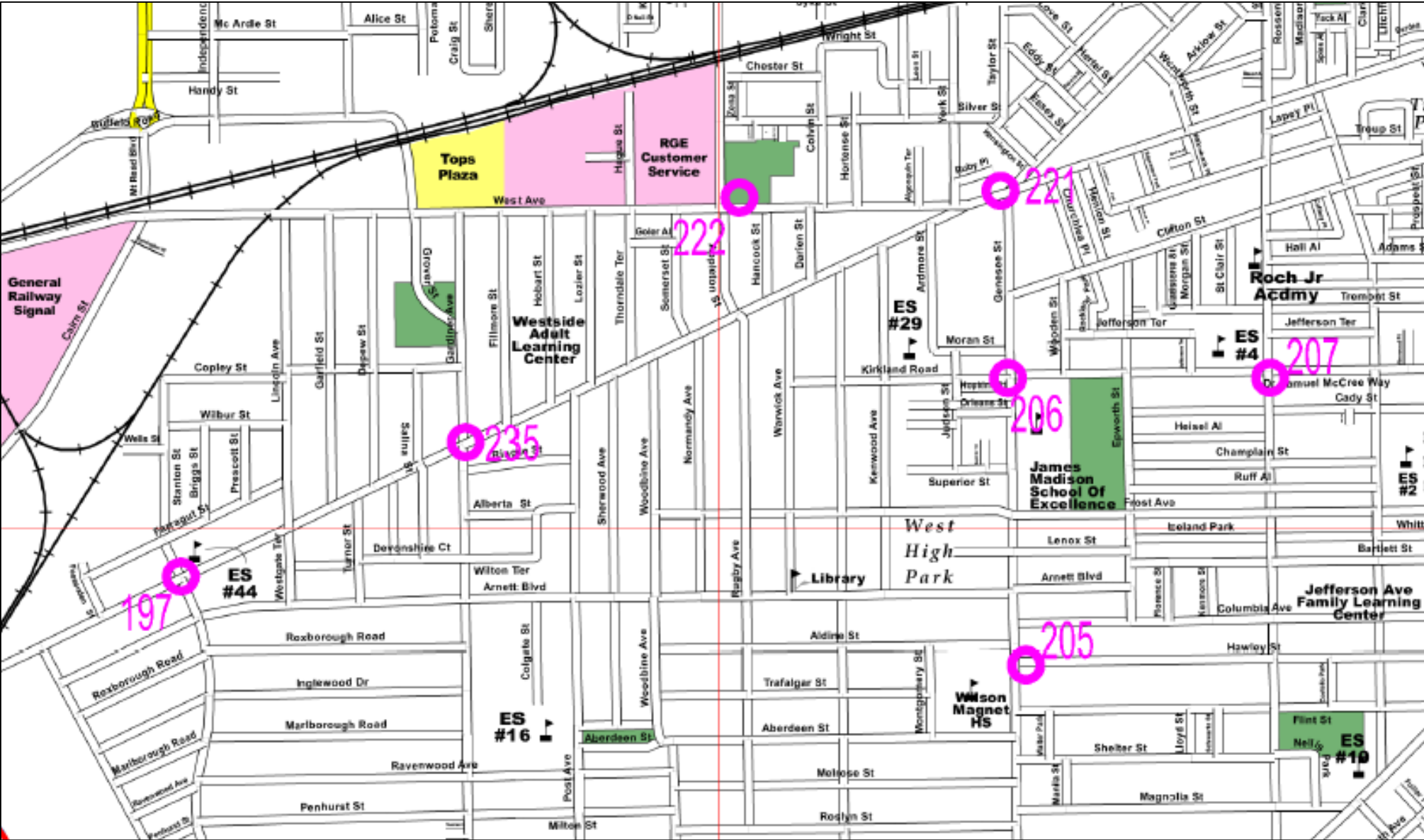

V. NYSDOT PSAP Locations

Bumpouts

1. Exchange Blvd at the Public Safety Building
2. Exchange Blvd at Plymouth Ave South
3. East Ave at Lawrence St
4. Chili Ave at Post Ave
5. Plymouth Ave at pedestrian bridge to UR
6. Monroe Ave at Werner Park

Signalized Intersections

- St Paul Street at Ridge Road
- St Paul Street at 104 onramp
- Route 104 at South NY-104 Service Road
- Route 104 at North NY-104 Service Road
- Route 490 at Culver Road
- Route 490 at Culver Road
- Route 490 at South Goodman Street
- Route 490 at Broadway Street
- Plymouth Ave at Off-ramp to Inner Loop
- Plymouth Ave at W. Broad Street
- Plymouth Ave at Church Street.

1. Exchange Blvd at the Public Safety Building

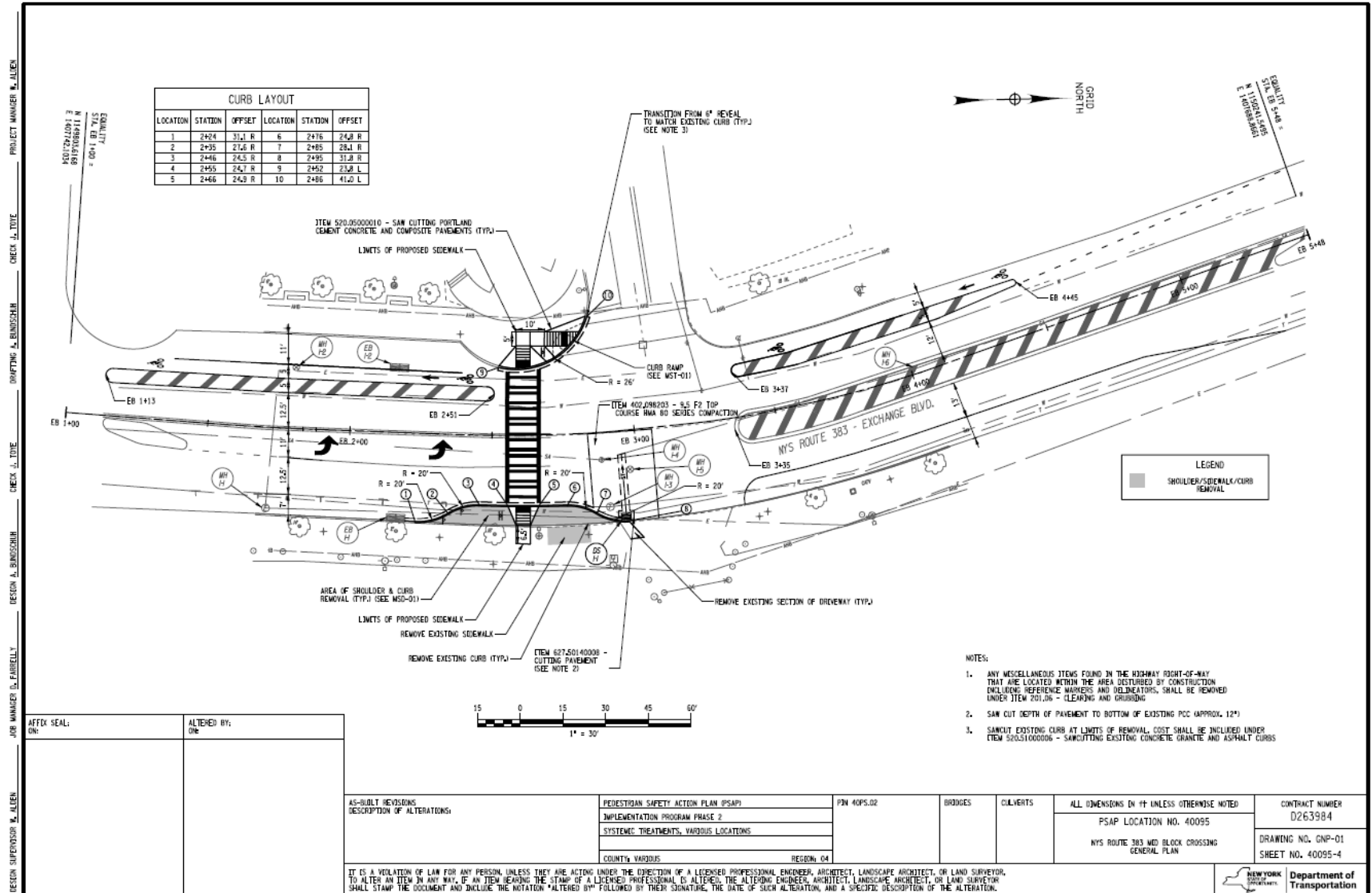
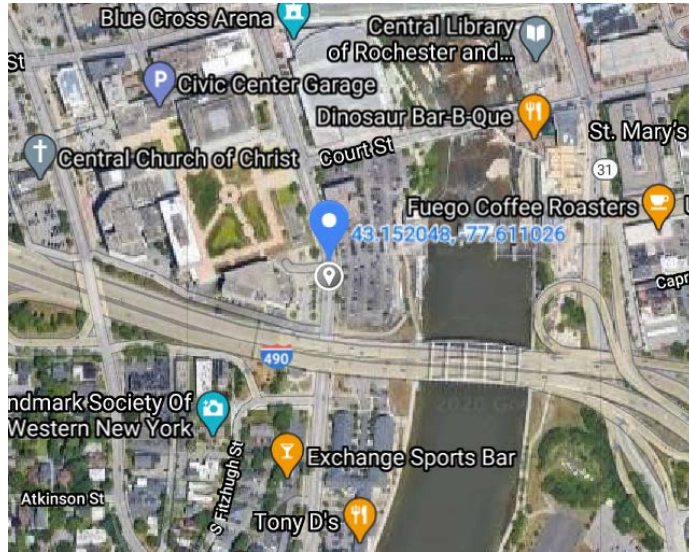

2. Exchange Blvd at Plymouth Ave South

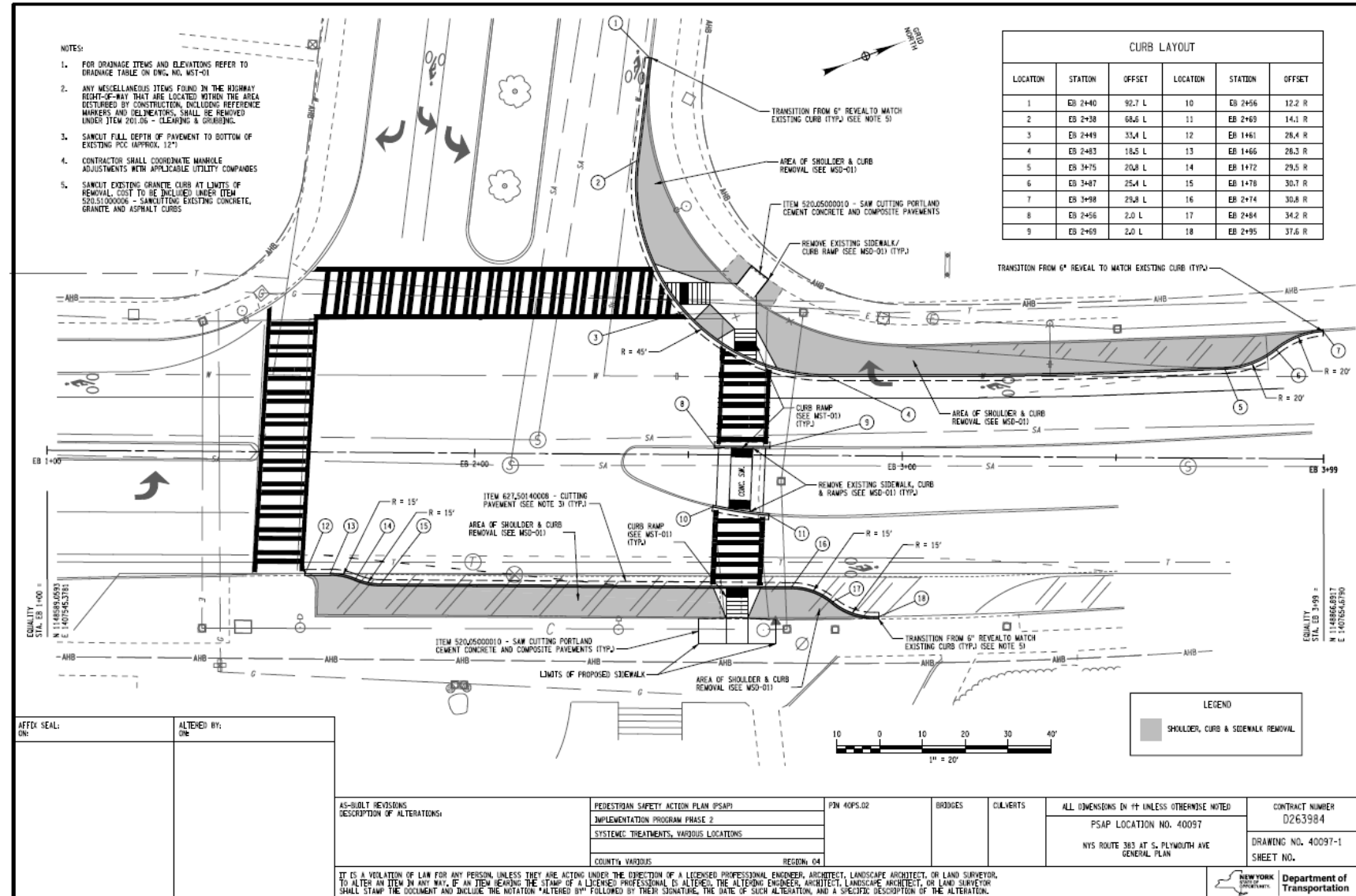
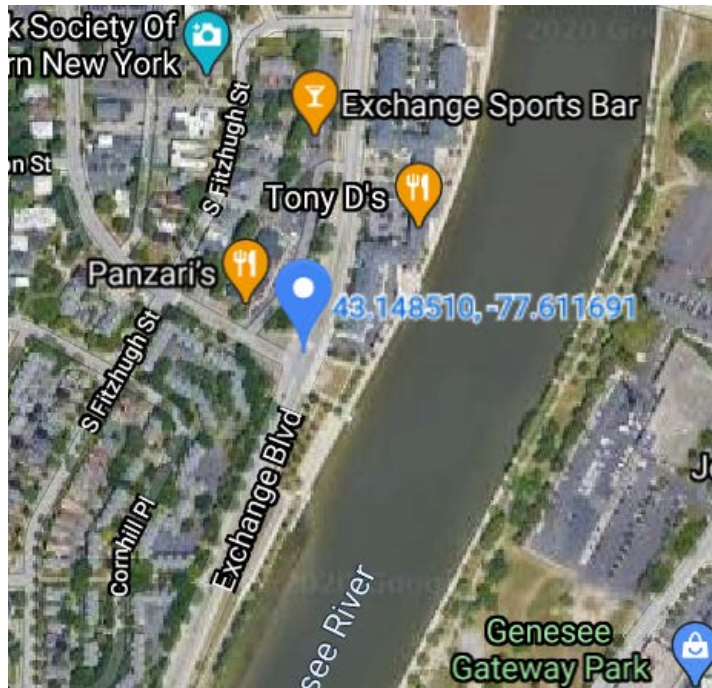

An aerial map of the East End neighborhood in New York City. The map shows a grid of streets including Union St, Lawrence St, Shuart St, East Ave, and Alexander St. Various businesses and landmarks are labeled with icons: Theatre closed (blue circle with 'X'), Arena's Inc Florist (blue circle with flower), Dermatology Partners of Western NY (red house icon), East End Apartments (green house icon), Filgers East End Takeout (orange fork and knife icon), One Nightclub (green house icon), The Daily Refresher Takeout (orange fork and knife icon), Skylark Lounge Takeout (orange fork and knife icon), 300 Alexander Apartments (green house icon), and Genesee (green house icon). A blue location pin is placed on East Ave with the text '43-155314, -77.595584' next to it.

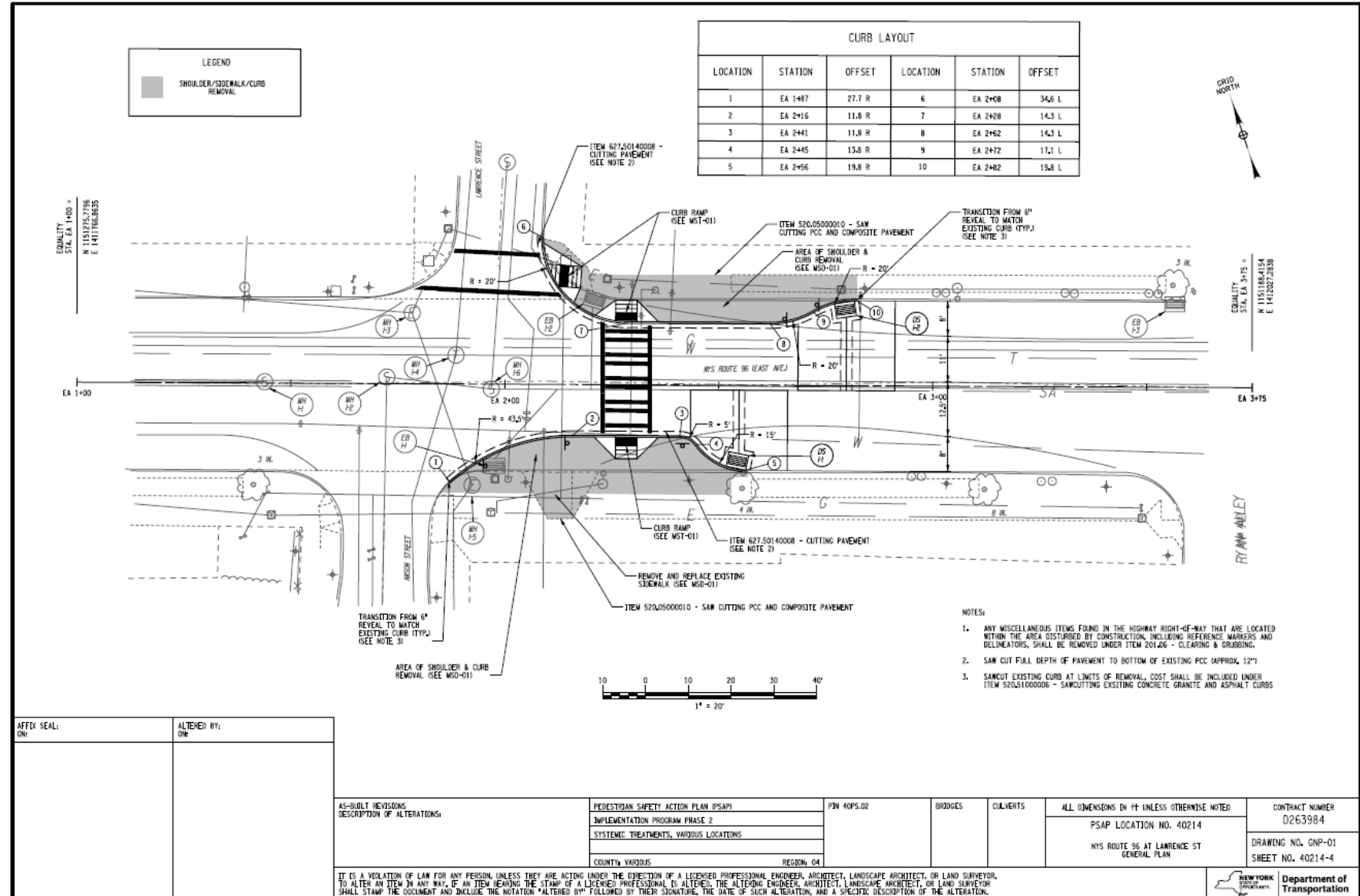

4. Chili Ave at Post Ave

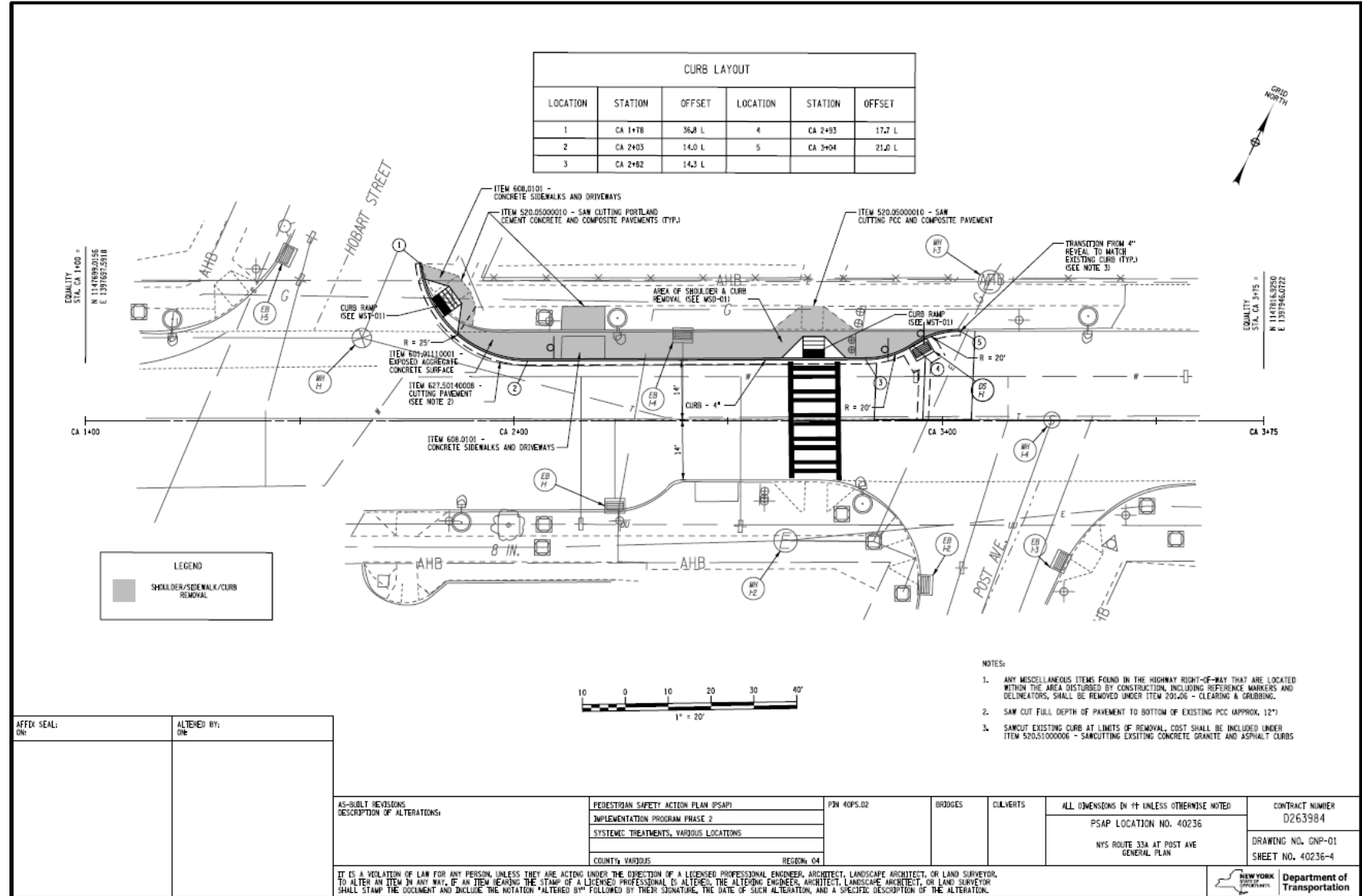
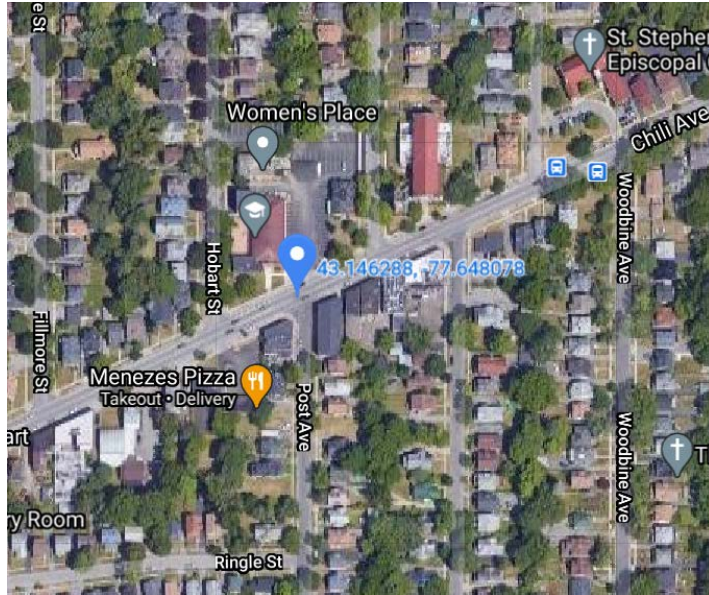

An aerial map of the Rochester, NY area, showing the Genesee River and surrounding landmarks. A blue location pin is placed on the Genesee Riverway Trail, with the coordinates 43.131285, -77.634741 displayed next to it. Other labeled locations include Plymouth Gardens, Brooks Landing Diner, Staybridge Suites, and the University of Rochester. The map also shows the Genesee River, Wilson Blvd, and the Sigma Phi Epsilon Fraternity.

LEGEND

 PAVEMENT, CONCRETE & CURB REMOVAL

[illegible]

AS-BUILT REVISIONS DESCRIPTION OF ALTERATIONS:	PEDESTRIAN SAFETY ACTION PLAN (PSAP)	PN 40PS.02 BRIDGES	CLIENTS	ALL DIMENSIONS IN FT UNLESS OTHERWISE NOTED	CONTRACT NUMBER D263984	
	IMPLEMENTATION PROGRAM PHASE 2			PSAP LOCATION NO. 40237		
	SYSTEMS, TREATMENTS, VARIOUS LOCATIONS			NYS ROUTE 393 MID BLOCK CROSSING GENERAL PLAN		DRAWING NO. CNP-01 SHEET NO. 40237-04
	COUNTY: VARIOUS			REGION: 04		

IT IS A VIOLATION OF LAW FOR ANY PERSON, UNLESS THEY ARE ACTING UNDER THE DIRECTION OF A LICENSED PROFESSIONAL ENGINEER, ARCHITECT, LANDSCAPE ARCHITECT, OR LAND SURVEYOR, TO ALTER IN ANY WAY, IF AN ITEM BEARING THE STAMP OF A LICENSED PROFESSIONAL, IS A LICENSED PROFESSIONAL ENGINEER, ARCHITECT, LANDSCAPE ARCHITECT, OR LAND SURVEYOR, SHALL STAMP THE DOCUMENT AND DISCLOSE THE NOTATION "ALTERED BY" FOLLOWED BY THEIR SIGNATURE, THE DATE OF SUCH ALTERATION, AND A SPECIFIC DESCRIPTION OF THE ALTERATION.

**Department of
Transportation**

6. Monroe Ave at Werner Park

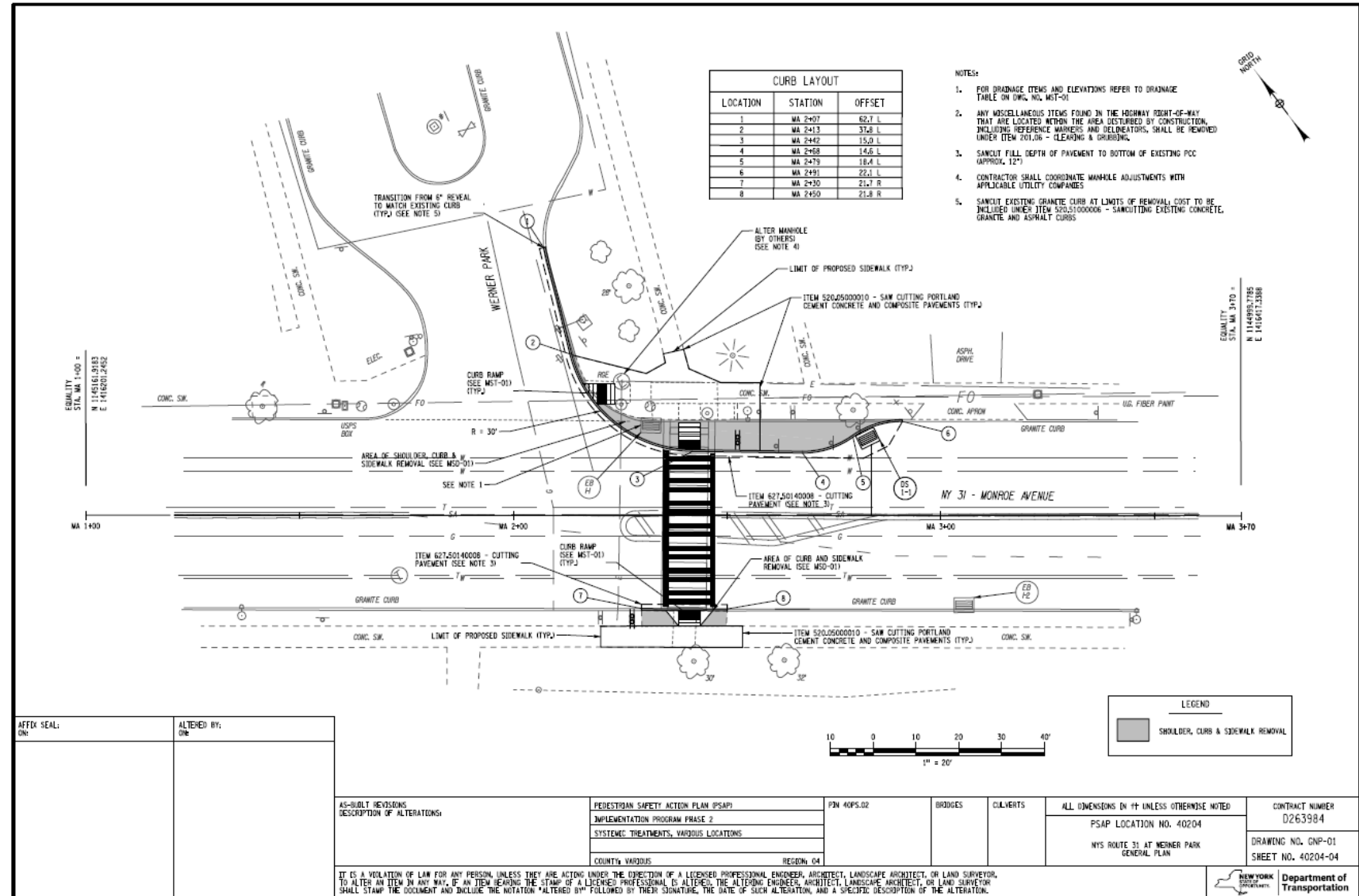
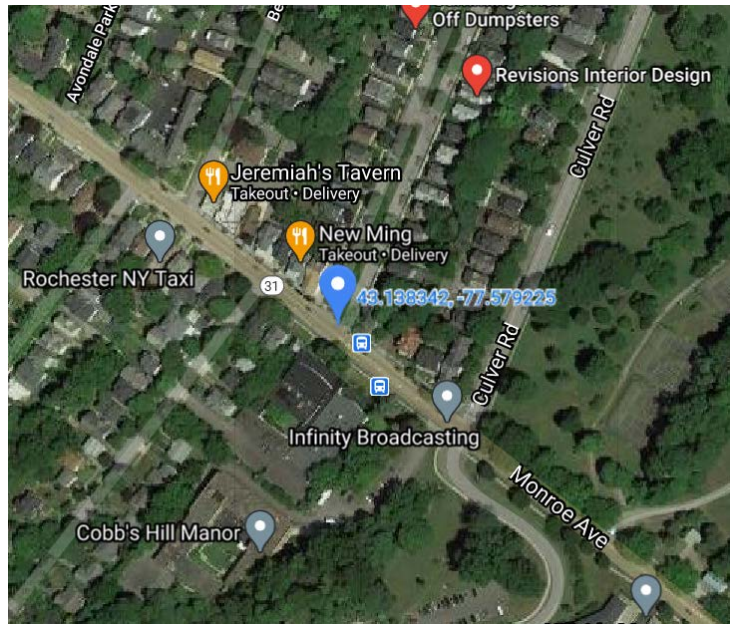

VI. Maintenance and Protection of Traffic

- Two-way traffic will be maintained, using flag persons when necessary.
- Most traffic calming elements will be installed without disruption.
- Most signal work will be completed without disruption.



VII. Project Schedule

- Final plans: December 2020
- Project out for bids: February 2021
- Successful project bidder approved by Council: April 2021
- Project construction begins: June 2021
- Project completion: October 2021



VIII. Questions and Answers

- Meeting participants on a computer can type Alt +Y (*or Option+Y if using a Mac*) to “raise your hand” to ask a question or simply click on the hand symbol  on your screen.
- Meeting participants on a phone can dial *9 to “raise your hand” to ask a question.

More information on City project: www.cityofrochester.gov/psap

More information on State Program:

<https://www.dot.ny.gov/divisions/operating/osss/highway/psap>

