

OUTER LIMIT CLASS D
CONCRETE ENCASEMENT
AND FULL DEPTH
PAVEMENT SAW CUT

LIMIT OF 3"
DEEP MILL

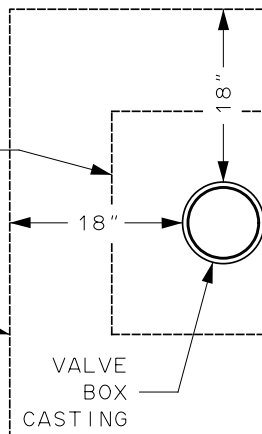

REHABILITATION

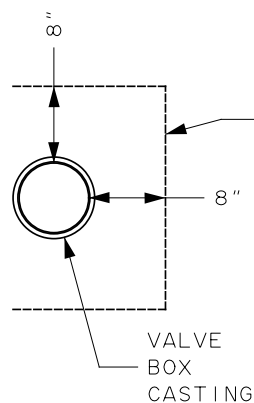

OUTER LIMIT CLASS D
CONCRETE ENCASEMENT

RECONSTRUCTION

PLANS

LIMITS AS SPECIFIED
IN CONTRACT DOCUMENTS
OR S101 SERIES DETAILS

PAVEMENT SECTION AND
LIMITS AS SPECIFIED
IN CONTRACT DOCUMENTS

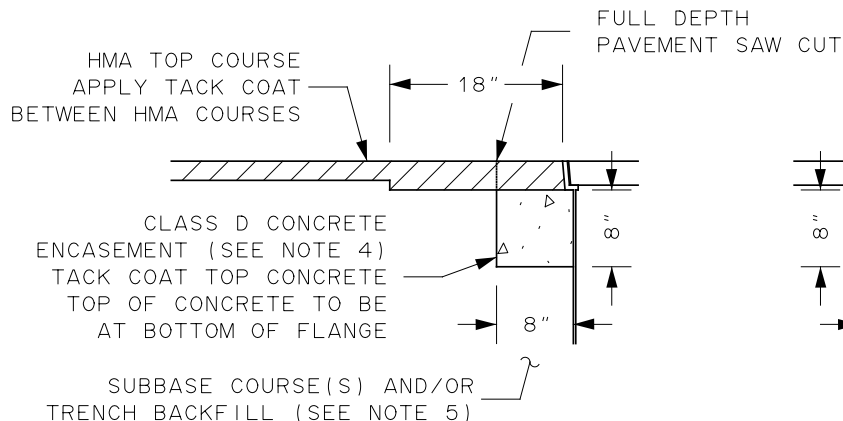

REHABILITATION

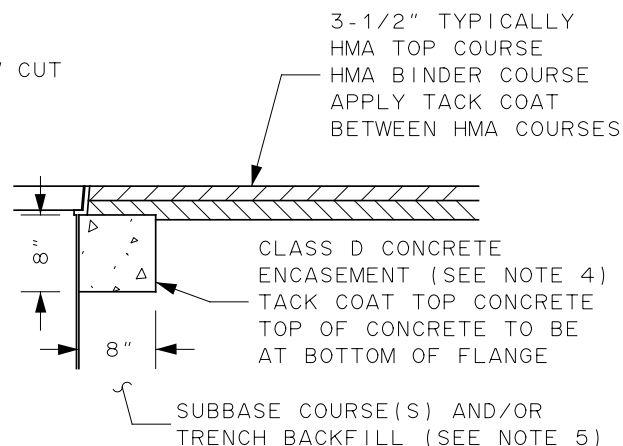

RECONSTRUCTION

SECTIONS

NOTES:

1. CASTING IS TO BE IN SAME HORIZONTAL PLANE AS SURROUNDING SURFACE, TRUE TO LINE AND GRADE, WITH COVER HAVING FULL CONTINUOUS AND UNIFORM BEARING CONTACT WITH FRAME.
2. TOP OF COVER IS TO BE LEVEL WITH TOP OF FRAME, STABLE AND IMMOVABLE WHEN IN PLACE AND WHEN UNDER INFLUENCE OF TRAFFIC OR ANY OTHER TYPE OF LOAD BEARING STRESS.
3. IF CASTING IS BELOW/ABOVE TOP OF SURROUNDING SURFACE GREATER THAN 1/4 INCH, IT IS DEFICIENT CONDITION THAT MUST BE MITIGATED PER DETAIL S100-01 OF "RULES AND REGULATIONS FOR WORK IN THE RIGHT-OF-WAY".
4. HIGH EARLY STRENGTH CONCRETE IS TO BE USED FOR PLACEMENTS REQUIRED TO SATISFY OPEN TO TRAFFIC TIME REQUIREMENTS.
5. SUBBASE AND/OR TRENCH BACKFILL MATERIALS ARE TO BE PLACED IN MAXIMUM 6 INCH THICK LAYERS AND COMPACTED TO 95% OF MODIFIED PROCTOR MAXIMUM DRY DENSITY TEST IN ACCORDANCE WITH ASTM D1557.

**THIS DETAIL MAY ONLY
BE USED IN CONJUNCTION
WITH PAVEMENT
REHABILITATION
OR RECONSTRUCTION**

CITY OF ROCHESTER

ASPHALT PAVEMENT
RESTORATION
FOR VALVE BOX
WITHIN ROADWAY

ISSUED	6-24-19	NON-STANDARD
REVISED	7-27-21	DWG.NO.S909-2