

REHABILITATION

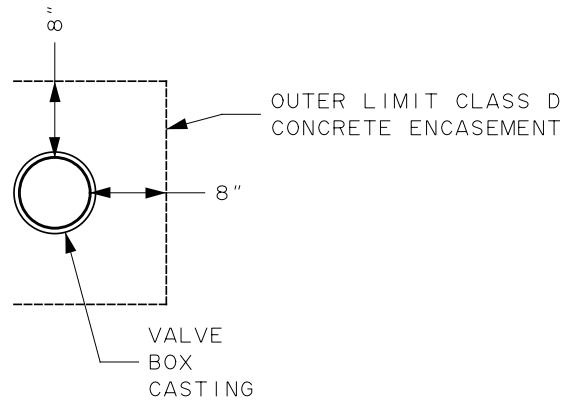

RECONSTRUCTION

PLANS

LIMITS AS SPECIFIED
IN CONTRACT DOCUMENTS
OR S101 SERIES DETAILS

PAVEMENT SECTION AND
LIMITS AS SPECIFIED
IN CONTRACT DOCUMENTS

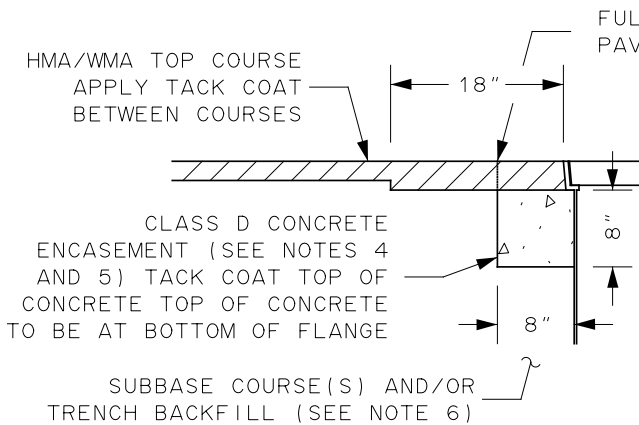

REHABILITATION

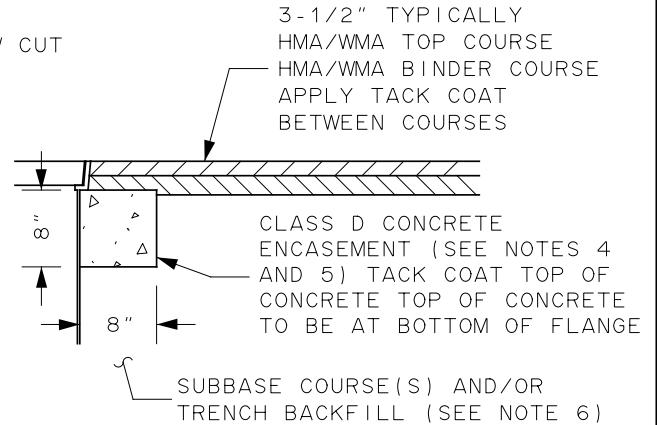

RECONSTRUCTION

SECTIONS

NOTES:

1. CASTING AND TOP OF CONCRETE ARE TO BE IN SAME HORIZONTAL PLANE AS SURROUNDING SURFACE, TRUE TO LINE AND GRADE, WITH COVER HAVING FULL CONTINUOUS AND UNIFORM BEARING CONTACT WITH FRAME.
2. TOP OF COVER IS TO BE LEVEL WITH TOP OF FRAME, STABLE AND IMMOVABLE WHEN IN PLACE AND WHEN UNDER INFLUENCE OF TRAFFIC OR ANY OTHER TYPE OF LOAD BEARING STRESS.
3. IF CASTING IS BELOW/ABOVE TOP OF SURROUNDING SURFACE GREATER THAN 1/4 INCH, IT IS DEFICIENT CONDITION THAT MUST BE MITIGATED PER DETAIL S100-01 OF "RULES AND REGULATIONS FOR WORK IN THE RIGHT-OF-WAY".
4. HIGH EARLY STRENGTH CONCRETE IS TO BE USED FOR PLACEMENTS REQUIRED TO SATISFY OPEN TO TRAFFIC TIME REQUIREMENTS.
5. DURING AND AFTER DEPOSITION OF CONCRETE PERFORM MODERATE VIBRATION AND COMPACTION TO EXPEL LARGE BUBBLES AND EXCESS OF ENTRAPPED AIR FROM FRESHLY PLACED CONCRETE IN ACCORDANCE WITH NYS DOT SECTION 555-3.04 HANDLING AND PLACING CONCRETE.

6. SUBBASE AND/OR TRENCH BACKFILL MATERIALS ARE TO BE PLACED IN MAXIMUM 6" THICK LAYERS AND COMPACTED TO 95% OF MODIFIED PROCTOR MAXIMUM DRY DENSITY TEST IN ACCORDANCE WITH ASTM D1557

**THIS DETAIL MAY ONLY BE
USED IN CONJUNCTION WITH
PAVEMENT REHABILITATION
OR RECONSTRUCTION**

CITY OF ROCHESTER		
ASPHALT PAVEMENT RESTORATION FOR VALVE BOX WITHIN ROADWAY		
ISSUED	6-24-19	NON-STANDARD DWG.NO.S909-2
REVISED	12-10-21	