

September 2016

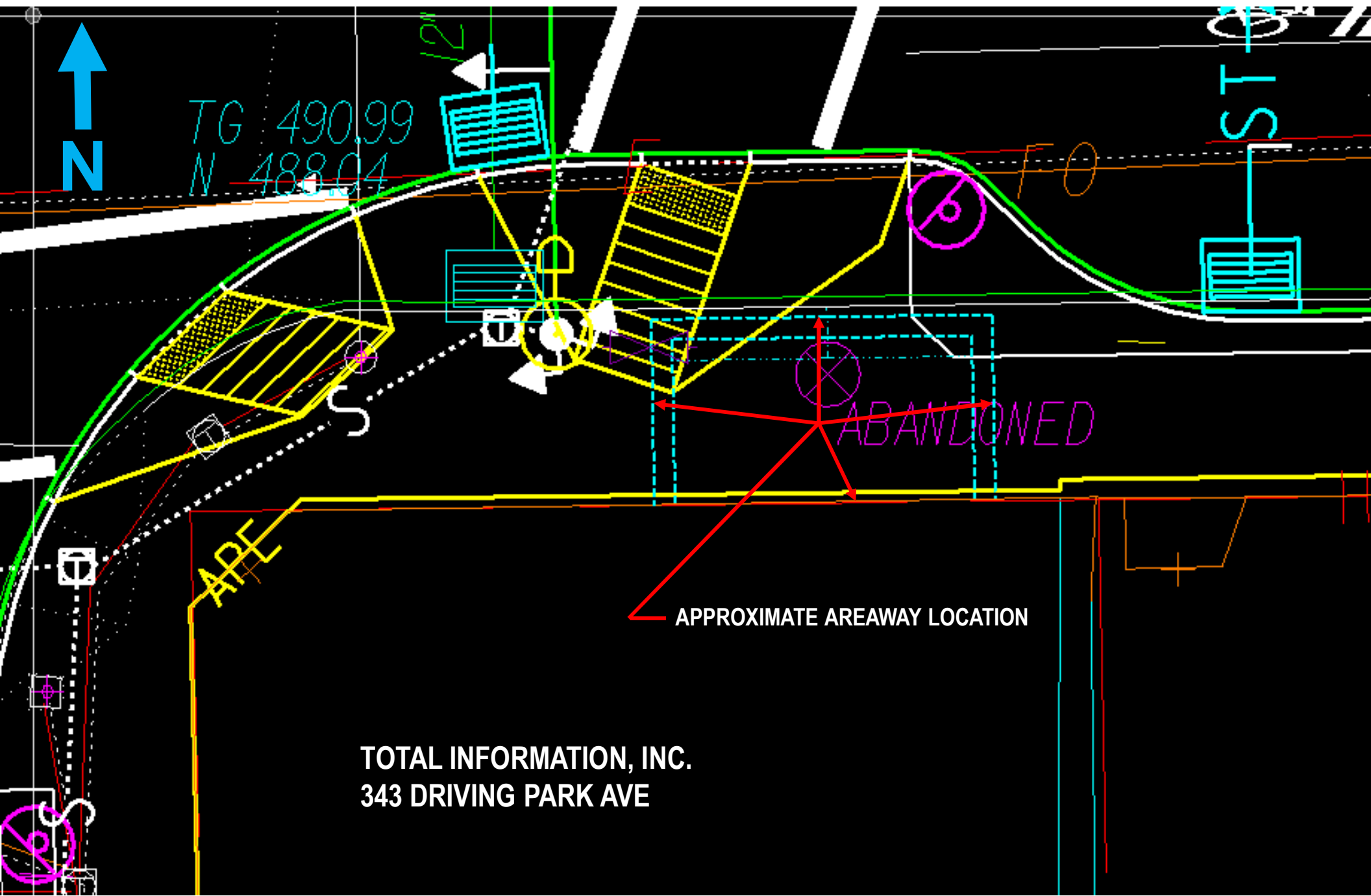

PIN 4755.55

Dewey Ave at Driving Park Ave Intersection Realignment Project

City of Rochester

343 Driving Park Ave Preliminary Areaway Review

September 2016



Figure 1: Looking east



PIN 4755.55

Dewey Ave at Driving Park Ave Intersection Realignment Project

City of Rochester

343 Driving Park Ave Preliminary Areaway Review

September 2016



Figure 2: Looking east

PIN 4755.55

Dewey Ave at Driving Park Ave Intersection Realignment Project

City of Rochester

343 Driving Park Ave Preliminary Areaway Review

September 2016



Figure 3: Looking south into basement



PIN 4755.55

Dewey Ave at Driving Park Ave Intersection Realignment Project

City of Rochester

343 Driving Park Ave Preliminary Areaway Review

September 2016



Figure 4: Looking south into basement

PIN 4755.55

Dewey Ave at Driving Park Ave Intersection Realignment Project

City of Rochester

343 Driving Park Ave Preliminary Areaway Review

September 2016



Figure 5: Looking west



**RAVI ENGINEERING & LAND SURVEYING, P.C.**

2110 South Clinton Avenue, Suite 1

Rochester, New York 14618

(585) 223-3660

FAX: (585) 223-4250

PROJECT NO. \_\_\_\_\_ TITLE: \_\_\_\_\_

SUBJECT: Dewey Ave + Driving Park

BY \_\_\_\_\_ DATE \_\_\_\_\_ CHECKED BY \_\_\_\_\_ DATE: 9/14/16

SHEET \_\_\_\_\_ OF \_\_\_\_\_ SCALE \_\_\_\_\_

